

# DE LUXE 490 KMF

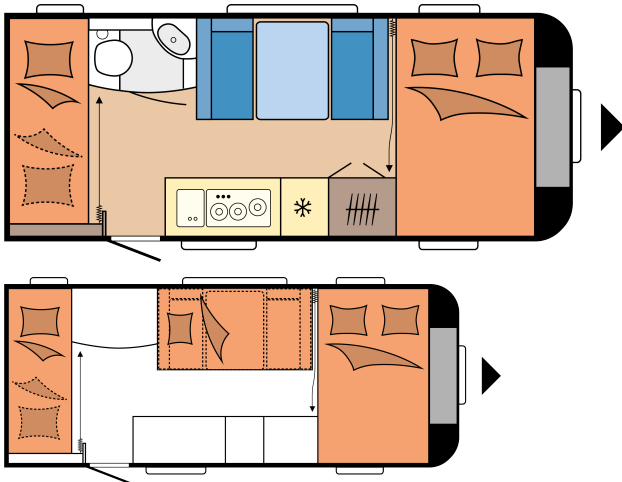

## FLOORPLAN



Overall length	6.892 mm
Total width	2.300 mm
Technically permissible gross weight	1.500 kg

Note: The vehicles shown are model examples. Illustrations may vary.

## TECHNICAL DATA

Model	490 KMF	Awning circumference	9.470 mm
Number of axles	1	Beading (straight edge)	3.715
Tyre size	185 R 14 C	Number of berths (adults / children)	3 / 2
Overall length	6.892 mm	Bed size, double bed (length x width)	2.070 x 1.280 mm
Body length	5.708 mm	Bed size, children's beds (length x width)	2.000 x 725; 2.000 x 700 mm
Overall width / Inside width	2.300 / 2.172 mm	Bed size, seating area bed conversion (length x width)	1.850 x 980 mm
Overall height / Interior headroom	2.635 / 1.950 mm	Autonomy package	Front left
Maximum technically permissible laden mass	1.500 kg	Roof-mounted air conditioning unit	Front
Mass in running order	1.264 kg	TV bracket	Bed / wardrobe
Payload	236 kg	Fresh water tank; city water connection, optional	Front left
Technically possible increase in load capacity to	1.800 kg	External gas socket	Front right
Payload after maximum increase in load capacity	511 kg	Exterior awning socket	Front right
Technically possible decrease in load capacity to	1.400 kg	Locker door, THETFORD with central locking, 752 x 310 mm, lockable	Front right
Body wall thickness (floor / roof / wall)	37 / 31 / 31 mm	Number of 230 V power sockets (single / double)	4 / 1

## HOBBYKOMPLETT

Chassis / Safety: Jockey wheel, Drawbar cover, One-key locking system, Integrated 3rd brake light, Rear fog light, Wheel shock absorbers, Tyre repair set, Heavy-duty supports, Load indicator on the jockey wheel, Licensed for up to 100 kph, Stabiliser hitch KNOTT, Overrun brake KNOTT ANS with automatic adjustment | Wheel Rims: Steel rims, silver with wheel covers | Windows: Hinged window, can be opened, double-glazed and tinted, Front window with fully integrated pleated blackout blind and insect screen, Combi Cassette with pleated blind and fly screen, for all windows (excluding washroom) | Body: Rooflight DOMETIC SEITZ, Midi-Heki 700 x 500 mm, with pleated blind and fly screen in living area, Rooflight DOMETIC SEITZ, Micro-Heki 280 x 280 mm, with pleated blind and fly screen in washroom, Winter vents for seating area, lockers and beds, One-piece entrance door, extra wide with triple-point locking, window, waste bin, compartments and pleated insect screen in door frame, design dependent on model, Grab handle, Entrance step, Integrated awning rail, Awning rail rain deflector with water drainage, front / rear, Wheel arches, thermally insulated, Wheel arch guard with

Furniture finish: Baron Elm / White Matt / Grace / Grey | Upholstery combinations: Turo | Kitchen: Refrigerator DOMETIC, 133 litres, 10 series, including 12-litre freezer compartment, double-hinged, absorption technology, Cooker and sink in stainless steel with 3-burner hob, electric ignition and split glass cover, Drawers, generously sized, fully extendable, with soft-close and push lock mechanisms, Cutlery insert, Towel rail, Kitchen window roller blind with integrated power sockets and kitchen light | Sleeping area: Double bed, Children's bed, 2 tiers with guard and ladder, Lower children's bed foldable, colouring board on underside, Sprung mattresses on single, double and queen-size beds, Bed lift for slatted frame with gas spring for double beds and queen-size beds | Washroom: Compact washroom with washbasin and toilet, design dependent on model, Cassette toilet THETFORD | Water / gas / electricity: Waste water tank, 23.5 litres, rollable, Fresh water tank, 25 litres, Submersible pump, Gas regulator with over-pressure protection (DIN EN 12 864) and hose line, Gas control taps in kitchen unit, Control panel for lighting system and tank display, Light switch for children, Electronically controlled

rubber lip for draught skirt, LED awning light, Gas locker, accommodates 2 x 11 kg bottles, Locker door, THETFORD with central locking, 752 x 310 mm, lockable | Living area: Single-post lift table, Wardrobe with interior light, Wall units with plenty of storage space and soft-close doors, Compartment under seating area |

12 V / 350 VA power supply, Ground fault circuit breaker, Antenna socket with co-axial cable in living area, Passenger vehicle connector JAEGER, 13-pole, Smoke alarm | LED lighting: Reading lights in seating area, Reading lights in sleeping area, Children's bed lights, dimmable with a night light and A/C USB ports | Smart Home: HOBBY CONNECT, controls for on-board technology via Hobby control panel and Bluetooth using app | Heating / air conditioning: Heating system TRUMA S-3004 with warm air unit and 12 V fan, Boiler TRUMA for hot water supply |

## OPTIONAL EXTRAS

### Chassis / Safety

Spare wheel with holder, instead of tyre repair set, underfloor mounting	26 kg
Stabilisation system KNOTT ETS Plus	5,7 kg
Hitch lock anti-theft device KNOTT "KS 25"	0,3 kg

### Increase / decrease in load capacity

Decrease in load capacity to 1,400 kg, without any technical modifications	
Increase in load capacity to 1,550 kg, without any technical modifications	
Increase in load capacity to 1,600 kg, with technical modification for single-axle vehicles, up to model 560	25 kg
Increase in load capacity to 1,800 kg, with technical modification for single-axle vehicles, up to model 560	25 kg

### Wheel Rims

Alloy rims silver, up to model 595	
Alloy rims black, polished, up to model 595	

### Body

Roof awning THULE OMNISTOR 6300, width 350 cm, pull-out depth 250 cm	29 kg
Bicycle rack THULE, for drawbar, 2 bicycles, loading capacity 60 kg	10 kg
Garage under bunk bed (not in conjunction with hot water heater ALDE, colouring board under children's bed removed)	5 kg

### Living area

Carpet in the living area, removable	10 kg
--------------------------------------	-------

### Upholstery combinations

Pico	
------	--

### Kitchen

Extractor hood DOMETIC including Hobby 10-stage speed control	3 kg
---	------

## Sleeping area

Bedsread	1,5 kg
----------	--------

## Water / gas / electricity

Fresh water tank, 47 litres	25 kg
Gas pressure regulator TRUMA DuoControl including automatic changeover, crash sensor and gas filter	2,2 kg
Smart Trailer System (vehicle levelling and fuel level indicator via E-Trailer app)	0,8 kg
Exterior awning socket, including 230 V output, satellite / TV connection	0,4 kg
City water connection	0,5 kg
External gas socket	1,5 kg
Electric boiler TRUMA, 14 litres (locker door can be removed)	15 kg
Water pump with additional switch	0,4 kg
Autonomy package including charge controller with booster, battery (AGM, 95 Ah), battery sensor and battery case	29 kg
Autonomy package with lithium battery SUPER B Epsilon, 12 V / 150 Ah	19,1 kg
Pre wiring for autonomy package including charge controller with booster, battery sensor and battery case	2,8 kg
Carbon monoxide detector	0,5 kg
Dual USB charging socket	0,1 kg

## LED lighting

Ambient lighting, design dependent on model	0,3 kg
---	--------

## Heating / air conditioning

Auxiliary electric heater TRUMA Ultraheat including CI-BUS	2 kg
Underfloor heating up to model 540	4 kg
Roof-mounted air conditioning unit DOMETIC FreshJet including CI-BUS, with heating function, without lighting, 2.2 KW	32 kg
Pre wiring for roof-mounted air conditioning unit	1,5 kg

## Multimedia

Articulated TV bracket including required connections, without video cables (Cinch)	2 kg
---	------