

DE LUXE 515 UHK

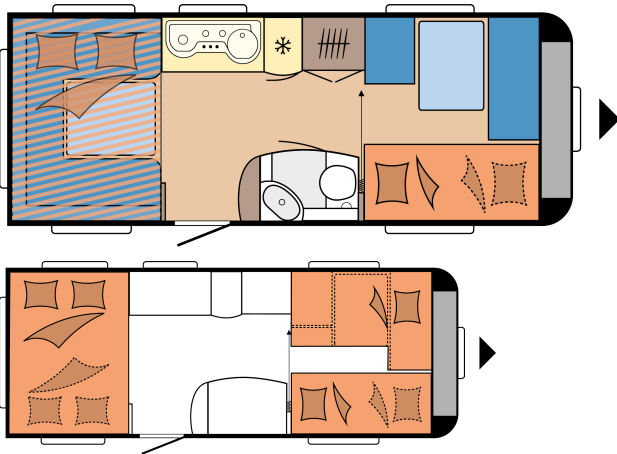

Overall length	7.531 mm
Total width	2.300 mm
Technically permissible gross weight	1.600 kg

TECHNICAL DATA

Model	515 UHK	Beading (straight edge)	4.360
Number of axles	1	Number of berths (adults / children)	5 / 2
Tyre size	185 R 14 C	Bed size, children's beds (length x width)	1.800 x 700; 1.850 x 700 mm
Overall length	7.531 mm	Bed size, drop-down bed (length x width)	2.000 x 1.290 mm
Body length	6.341 mm	Bed size, seating area bed conversion (length x width)	2.038 x 1.600; 1.890 x 1.275 / 980 mm
Overall width / Inside width	2.300 / 2.172 mm	Autonomy package	Front centre
Overall height / Interior headroom	2.637 / 1.950 mm	Roof-mounted air conditioning unit	Centre
Maximum technically permissible laden mass	1.600 kg	TV bracket	Sideboard
Mass in running order	1.443 kg	Fresh water tank; city water connection, optional	Rear right
Payload	157 kg	External gas socket	Rear right
Technically possible increase in load capacity to	2.000 kg	Exterior awning socket	Rear right
Payload after maximum increase in load capacity	521 kg	Locker door, THETFORD with central locking, 752 x 310 mm, lockable	Rear left
Body wall thickness (floor / roof / wall)	39 / 31 / 31 mm	Number of 230 V power sockets (single / double)	4 / 1
Awning circumference	10.120 mm		

HOBBYKOMPLETT

Chassis / Safety: Stabiliser hitch KNOTT, Overrun brake KNOTT ANS with automatic adjustment, Jockey wheel, Drawbar cover, One-key locking system, Integrated 3rd brake light, Rear fog light, Wheel shock absorbers, Tyre repair set, Heavy-duty supports, Load indicator on the jockey wheel, Licensed for up to 100 kph | Wheel Rims: Steel rims, silver with wheel covers | Windows: Hinged window, can be opened, double-glazed and tinted, Front window with fully integrated pleated blackout blind and insect screen, Combi Cassette with pleated blind and fly screen, for all windows (excluding washroom) | Body: Rooflight DOMETIC SEITZ, Midi-Heki 700 x 500 mm, with pleated blind and fly screen in living area, Rooflight DOMETIC SEITZ, Mini-Heki 400 x 400 mm, with pleated blind and fly screen in children's sleeping area, Rooflight DOMETIC SEITZ, Mini-Heki 400 x 400 mm, with pleated blind and fly screen above drop-down bed, Rooflight DOMETIC SEITZ, Micro-Heki 280 x 280 mm, with pleated blind and fly screen in washroom, One-piece entrance door, extra wide with triple-point locking, window, waste bin, compartments and pleated insect screen in door frame, design dependent on model, Grab handle, Entrance step, Integrated awning rail, Awning rail

Living area: Wardrobe with interior light, Wall units with plenty of storage space and soft-close doors, Compartment under seating area, TV unit with illuminated cabinet, Set of Hobby glasses | Furniture finish: Olmo Pavarotti / White | Upholstery combinations: Lago | Kitchen: Super Slim Tower refrigerator DOMETIC, 150 litres, including removable 15-litre freezer compartment, absorption technology, Stainless steel hob / sink combination with 3-burner hob, electric ignition and split glass cover, Drawers, generously sized, fully extendable, with soft-close and push lock mechanisms, Kitchen window roller blind with integrated power sockets and kitchen light, Cutlery insert | Sleeping area: Children's bed, 2 tiers with guard and ladder, Drop-down bed, Bed extension for the seating area | Washroom: Compact washroom with washbasin and toilet, design dependent on model, Cassette toilet THETFORD | Water / gas / electricity: Waste water tank, 23.5 litres, rollable, Fresh water tank, 47 litres, Submersible pump, Gas regulator with over-pressure protection (DIN EN 12 864) and hose line, Gas control taps in kitchen unit, Control panel for lighting system and tank display, Light switch for children, Electronically controlled 12 V /

rain deflector with water drainage, front / rear, Wheel arches, thermally insulated, Wheel arch guard with rubber lip for draught skirt, LED awning light, Gas locker, accommodates 2 x 11 kg bottles, Locker door, THETFORD with central locking, 752 x 310 mm, lockable, Winter vents for seating area, lockers and beds | Living area: Hook-on table, Metal lift table |

350 VA power supply, Ground fault circuit breaker, Antenna socket with co-axial cable in living area, Passenger vehicle connector JAEGER, 13-pole, Smoke alarm | Smart Home: HOBBY CONNECT, controls for on-board technology via Hobby control panel and Bluetooth using app | LED lighting: Corner shelves with lighting in seating area, design dependent on model, Swan neck lamps in children's seating area | Heating / air conditioning: Heating system TRUMA S-3004 with warm air unit and 12 V fan, Boiler TRUMA for hot water supply |

Chassis / Safety

Spare wheel with holder, instead of tyre repair set, underfloor mounting	26 kg
Stabilisation system KNOTT ETS Plus	5,7 kg
Hitch lock anti-theft device KNOTT "KS 25"	0,3 kg

Wheel Rims

Alloy rims silver, up to model 560

Alloy rims black, polished, up to model 560

Body

Rear lights with dynamic indicator	1 kg
Roof awning THULE OMNISTOR 6300, width 400 cm, pull-out depth 250 cm	33 kg
Bicycle rack THULE, for drawbar, 2 bicycles, loading capacity 60 kg	10 kg
Bicycle rack THULE, for rear, 2 bicycles, loading capacity 40 kg	7,5 kg
Garage under bunk bed (not in conjunction with hot water heater ALDE, colouring board under children's bed removed)	5 kg

Living area

Single-post lift table with innovative, one-handed operation	
Carpet in the living area, removable	10 kg

Upholstery combinations

Lago including decorative set

Sari including decorative set

Sari

Kitchen

Oven THETFORD with electric ignition, grill and interior light, 36 litres	15 kg
Extractor hood DOMETIC including Hobby 10-stage speed control	3 kg

Microwave, 20 litres and extractor hood DOMETIC	18 kg
---	-------

Water / gas / electricity

Gas pressure regulator TRUMA DuoControl including automatic changeover, crash sensor and gas filter	2,2 kg
Smart Trailer System (vehicle levelling and fuel level indicator via E-Trailer app)	0,8 kg
Exterior awning socket, including 230 V output, satellite / TV connection	0,4 kg
Adapter 7/13-pole for passenger vehicle connecting cable	0,3 kg
City water connection	0,5 kg
External gas socket	1,5 kg
Electric boiler TRUMA, 14 litres (locker door can be removed)	15 kg
Water pump with additional switch	0,4 kg
Autonomy package including charge controller with booster, battery, battery sensor and battery case	29 kg
Pre wiring for autonomy package including charge controller with booster, battery sensor and battery case	2,8 kg
Carbon monoxide detector	0,5 kg
Dual USB charging socket and children's bed lights including USB charging socket	0,1 kg

Smart Home

HOBBY-CONNECT+, remote control for on-board technology via mobile communications using app	0,6 kg
--	--------

LED lighting

Ambient lighting, design dependent on model	0,3 kg
---	--------

Heating / air conditioning

Auxiliary electric heater TRUMA Ultraheat including CI-BUS	2 kg
Underfloor heating up to model 540	4 kg
Roof-mounted air conditioning unit DOMETIC FreshJet including CI-BUS, with heating function, without lighting, 2.2 KW	32 kg
Pre wiring for roof-mounted air conditioning unit	1,5 kg

Multimedia

Articulated TV bracket including required connections, without video cables (Cinch)	2 kg
TV aerial mast TELECO	0,9 kg