

DE LUXE 560 KMFE

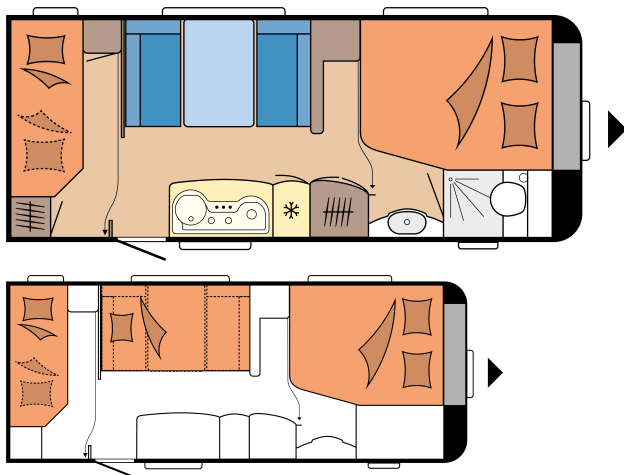

Overall length	7.510 mm
Total width	2.500 mm
Technically permissible gross weight	1.700 kg

TECHNICAL DATA

Model	560 KMFe
Number of axles	1
Tyre size	195 / 70 R 15 C
Overall length	7.510 mm
Body length	6.344 mm
Overall width / Inside width	2.500 / 2.367 mm
Overall height / Interior headroom	2.645 / 1.950 mm
Maximum technically permissible laden mass	1.700 kg
Mass in running order	1.504 kg
Payload	196 kg
Technically possible increase in load capacity to	2.000 kg
Payload after maximum increase in load capacity	485 kg
Body wall thickness (floor / roof / wall)	39 / 31 / 31 mm

Awning circumference	10.120 mm
Number of berths (adults / children)	3 / 2
Bed size, double bed (length x width)	1.950 x 1.570 / 1.280 mm
Bed size, children's beds (length x width)	1.840 x 730; 1.840 x 700 mm
Bed size, seating area bed conversion (length x width)	1.976 x 1.130 mm
Autonomy package	Front centre
Roof-mounted air conditioning unit	Centre
TV bracket	Seating area
Fresh water tank; city water connection, optional	Front left
External gas socket	Rear right
Exterior awning socket	Centre right
Locker door THETFORD with central locking, 752 x 310 mm, lockable	Front left
Number of 230 V power sockets (single / double)	5 / 1

HOBBYKOMPLETT

Chassis / Safety: Stabiliser hitch KNOTT, Overrun brake KNOTT ANS with automatic adjustment, Jockey wheel, Drawbar cover, One-key locking system, Integrated 3rd brake light, Rear fog light, Wheel shock absorbers, Tyre repair set, Heavy-duty supports, Load indicator on the jockey wheel, Licensed for up to 100 kph |

Wheel Rims: Steel rims, silver with wheel covers |

Windows: Hinged window, can be opened, double-glazed and tinted, Front window with fully integrated pleated blackout blind and insect screen, Combi Cassette with pleated blind and fly screen, for all windows (excluding washroom) | **Body:** Rooflight DOMETIC SEITZ, Midi-Heki 700 x 500 mm, with pleated blind and fly screen in living area, Rooflight DOMETIC SEITZ, Mini-Heki 400 x 400 mm, with pleated blind and fly screen in sleeping area, Rooflight DOMETIC SEITZ, Mini-Heki 400 x 400 mm, with pleated blind and fly screen in children's sleeping area, One-piece entrance door, extra wide with triple-point locking, window, waste bin, compartments and pleated insect screen in door frame, design dependent on model, Grab handle, Entrance step, Integrated awning rail, Awning rail rain deflector with water drainage, front / rear, Wheel arches, thermally insulated, Wheel arch guard with rubber lip for draught skirt, LED awning light, Gas locker,

Furniture finish: Olmo Pavarotti / Uni Beige Matt | **Upholstery combinations:** Patch | **Kitchen:** Super Slim Tower refrigerator DOMETIC, 150 litres, including removable 15-litre freezer compartment, Stainless steel hob / sink combination with 3-burner hob, electric ignition and split glass cover, Drawers, generously sized, fully extendable, with soft-close and push lock mechanisms, Kitchen window roller blind with integrated power sockets and kitchen light, Cutlery insert, Towel rail | **Sleeping area:** Double bed, Children's bed, 2 tiers with guard and ladder, Lower children's bed foldable, colouring board on underside, Sprung mattresses on single, double and queen-size beds, Bed lift for slatted frame with gas spring for double beds and queen-size beds |

Washroom: Compact washroom with integrated shower tray and external washbasin, Cassette toilet THETFORD, Hinged window with frosted glass look, can be opened | **LED lighting:** Swan neck lamps in seating area, Swan neck lamps in sleeping area | **Heating / air conditioning:** Heating system TRUMA S-5004 with warm air unit and 12 V fan, Boiler TRUMA for hot water supply, Winter vents for seating area, lockers and beds | **Water / gas / electricity:** Waste water tank, 23.5 litres, rollable, Fresh water tank, 47 litres, Submersible pump, Gas regulator with over-

accommodates 2 x 11 kg bottles, Locker door THETFORD with central locking, 752 x 310 mm, lockable | **Living area:** Single-post lift table, Wardrobe with interior light, Wall units with plenty of storage space and soft-close doors, Compartment under seating area |

pressure protection (DIN EN 12 864) and hose line, Gas control taps in kitchen unit, Control panel for lighting system and tank display, Light switch for children, Electronically controlled 12 V / 350 VA power supply, Ground fault circuit breaker, Antenna socket with co-axial cable in living area, Passenger vehicle connector JAEGER, 13-pole, Smoke alarm |

Upholstery combinations

Sari	
Patch including rose/yellow decorative set	1,3 kg
Sari including rose/yellow decorative set	1,3 kg

Body

Roof awning THULE OMNISTOR 6300, width 400 cm, pull-out depth 250 cm	33 kg
Rear lights with dynamic indicator	1 kg
Bicycle rack THULE, for drawbar, 2 bicycles, loading capacity 60 kg	10 kg
Bicycle rack THULE, for rear, 2 bicycles, loading capacity 40 kg	7,5 kg
Garage under bunk bed (not in conjunction with hot water heater ALDE, colouring board under children's bed removed)	5 kg

Kitchen

Microwave, 20 litres and extractor hood DOMETIC	18 kg
Oven THETFORD with electric ignition, grill and interior light, 36 litres	15 kg
Extractor hood DOMETIC including Hobby 10-stage speed control	3 kg

Water / gas / electricity

Carbon monoxide detector	0,5 kg
Gas pressure regulator TRUMA DuoControl including automatic changeover, crash sensor and gas filter	2,2 kg
Exterior awning socket, including 230 V output, satellite / TV connection	0,4 kg
Adapter 7/13-pole for passenger vehicle connecting cable	0,3 kg
City water connection	0,5 kg
External gas socket	1,5 kg
Electric boiler TRUMA, 14 litres (locker door can be removed)	15 kg
Water pump with additional switch	0,4 kg
Autonomy package including charge controller with booster, battery, battery sensor and battery case	29 kg
Pre wiring for autonomy package including charge controller with booster, battery sensor and battery case	2,8 kg
Wireless remote control for the lighting system with one handset	0,3 kg
Dual USB charging socket and children's bed lights including USB charging socket	0,1 kg

Smart Home

HOBBY CONNECT, controls for on-board technology via TFT control panel and Bluetooth using app	0,1 kg
HOBBY-CONNECT+, remote control for on-board technology via mobile communications using app	0,6 kg

Chassis / Safety

Hitch lock anti-theft device KNOTT "KS 25"	0,3 kg
Spare wheel with holder, instead of tyre repair set, underfloor mounting	26 kg
Stabilisation system KNOTT ETS Plus	5,7 kg

Wheel Rims

Alloy rims silver, up to model 560
Alloy rims black, polished, up to model 560

Living area

Carpet in the living area, removable	10 kg
--------------------------------------	-------

Sleeping area

Cold foam mattress, with 7 zones and slatted bed base for double bed and queen-size bed	2,9 kg
Children's bed, 3 tiers with guard and ladder	15 kg
Bedspread	1,5 kg

Washroom

Shower fitting and shower curtain for washroom with external washbasin	2,8 kg
Blackout blind including insect screen for washroom	1,5 kg
Clothes rail in the shower	0,5 kg

LED lighting

Ambient lighting, design dependent on model	0,3 kg
---	--------

Heating / air conditioning

Auxiliary electric heater TRUMA Ultraheat including CI-BUS	2 kg
Underfloor heating from model 545	6 kg
Hot water heater ALDE COMPACT 3020 HE including CI-BUS	41,5 kg
Roof-mounted air conditioning unit DOMETIC FreshJet including CI-BUS, with heating function, without lighting, 2.2 KW	32 kg
Pre wiring for roof-mounted air conditioning unit	1,5 kg

Multimedia

Articulated TV bracket including required connections, without video cables (Cinch)	2 kg
TV aerial mast TELECO	0,9 kg