

EXCELLENT EDITION 490 KMF

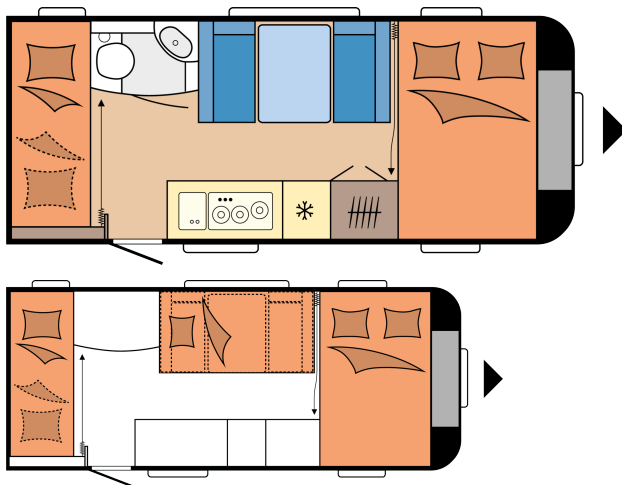

Overall length	6.886 mm
Total width	2.300 mm
Technically permissible gross weight	1.400 kg

TECHNICAL DATA

Model	490 KMF	Beading (straight edge)	3.715
Number of axles	1	Number of berths (adults / children)	3 / 2
Tyre size	185 R 14 C	Bed size, double bed (length x width)	2.070 x 1.280 mm
Overall length	6.886 mm	Bed size, children's beds (length x width)	2.000 x 725; 2.000 x 700 mm
Body length	5.696 mm	Bed size, seating area bed conversion (length x width)	1.850 x 980 mm
Overall width / Inside width	2.300 / 2.172 mm	Autonomy package	Front left
Overall height / Interior headroom	2.635 / 1.950 mm	Roof-mounted air conditioning unit	Front
Maximum technically permissible laden mass	1.400 kg	TV bracket	Bed / wardrobe
Mass in running order	1.261 kg	Fresh water tank; city water connection, optional	Front left
Payload	139 kg	External gas socket	Front right
Technically possible increase in load capacity to	1.800 kg	Exterior awning socket	Front right
Payload after maximum increase in load capacity	533 kg	Locker door, THETFORD with central locking, 752 x 310 mm, lockable	Front right
Body wall thickness (floor / roof / wall)	37 / 31 / 31 mm	Number of 230 V power sockets (single / double)	5 / 1
Awning circumference	9.470 mm		

HOBBYKOMPLETT

Chassis / Safety: Jockey wheel, Drawbar cover, One-key locking system, Integrated 3rd brake light, Rear fog light, Wheel shock absorbers, Tyre repair set, Heavy-duty supports, Load indicator on the jockey wheel, Licensed for up to 100 kph, Stabiliser hitch KNOTT, Overrun brake KNOTT ANS with automatic adjustment | Wheel Rims: Steel rims, silver with wheel covers | Windows: Hinged window, can be opened, double-glazed and tinted, Front window with fully integrated pleated blackout blind and insect screen, Combi Cassette with pleated blind and fly screen, for all windows (excluding washroom) | Body: Rooflight DOMETIC SEITZ, Midi-Heki 700 x 500 mm, with pleated blind and fly screen in living area, Rooflight DOMETIC SEITZ, Micro-Heki 280 x 280 mm, with pleated blind and fly screen in washroom, Winter vents for seating area, lockers and beds, One-piece entrance door, extra wide with triple-point locking, window, waste bin, compartments and pleated insect screen in door frame, design dependent on model, Grab handle, Entrance step, Integrated awning rail, Awning rail rain deflector with water drainage, front / rear, Wheel arches, thermally insulated, Wheel arch guard with rubber lip for draught skirt, LED awning light, Gas locker, accommodates 2 x 11 kg bottles, Locker door, THETFORD with

Upholstery combinations: Neo | Kitchen: Refrigerator DOMETIC, 133 litres, 10 series, including 12-litre freezer compartment, double-hinged, absorption technology, Stainless steel hob / sink combination with 3-burner hob, electric ignition and split glass cover, Spice racks, Drawers, generously sized, fully extendable, with soft-close and push lock mechanisms, Cutlery insert, Towel rail, Kitchen splashback with fully integrated blackout blind and insect screen, kitchen light, 230 V power sockets and USB charging socket, Kitchen light and separate power sockets | Sleeping area: Double bed, Children's bed, 2 tiers with guard and ladder, Lower children's bed foldable, colouring board on underside, Sprung mattresses on single, double and queen-size beds, Bed lift for slatted frame with gas spring for double beds and queen-size beds | Washroom: Compact washroom with washbasin and toilet, design dependent on model, Cassette toilet THETFORD | Water / gas / electricity: Waste water tank, 23.5 litres, rollable, Fresh water tank, 25 litres, Submersible pump, Gas regulator with over-pressure protection (DIN EN 12 864) and hose line, Gas control taps in kitchen unit, Control panel for lighting system and tank display, Light switch for children, Electronically controlled 12 V / 350 VA power supply, Ground fault circuit breaker, Exterior

central locking, 752 x 310 mm, lockable | Living area: Single-post lift table with innovative, one-handed operation, Wardrobe with interior light, Wall units with plenty of storage space and soft-close doors, Compartment under seating area | Furniture finish: Cape Town / White |

awning socket, including 230 V output, satellite / TV connection, Antenna socket with co-axial cable in living area, Passenger vehicle connector JAEGER, 13-pole, Smoke alarm | LED lighting: Ambient lighting, design dependent on model, Reading lights in seating area, Reading lights in sleeping area | Smart Home: HOBBY CONNECT, controls for on-board technology via Hobby control panel and Bluetooth using app | Heating / air conditioning: Heating system TRUMA S-3004 with warm air unit and 12 V fan, Boiler TRUMA for hot water supply |

Chassis / Safety

Spare wheel with holder, instead of tyre repair set, underfloor mounting

Stabilisation system KNOTT ETS Plus

Hitch lock anti-theft device KNOTT "KS 25"

Increase / decrease in load capacity

Increase in load capacity to 1,500 kg, without any technical modifications

Increase in load capacity to 1,550 kg, without any technical modifications

Increase in load capacity to 1,600 kg, with technical modification for single-axle vehicles, up to model 560

Increase in load capacity to 1,800 kg, with technical modification for single-axle vehicles, up to model 560

Wheel Rims

Alloy rims silver, up to model 595

Alloy rims black, polished, up to model 595

Body

Rear lights with dynamic indicator

Roof awning THULE OMNISTOR 6300, width 350 cm, pull-out depth 250 cm

Bicycle rack THULE, for drawbar, 2 bicycles, loading capacity 60 kg

Garage under bunk bed (not in conjunction with hot water heater ALDE, colouring board under children's bed removed)

Bicycle rack THULE, for rear, 2 bicycles, loading capacity 40 kg

Living area

Carpet in the living area, removable

Upholstery combinations

Neo including decorative set

Pico

Kitchen

Extractor hood DOMETIC including Hobby 10-stage speed control

Sleeping area

Bedsread

Water / gas / electricity

Fresh water tank, 47 litres

Gas pressure regulator TRUMA DuoControl including automatic changeover, crash sensor and gas filter

Smart Trailer System (vehicle levelling and fuel level indicator via E-Trailer app)

City water connection

External gas socket

Electric boiler TRUMA, 14 litres (locker door can be removed)

Water pump with additional switch

Autonomy package including charge controller with booster, battery (AGM, 95 Ah), battery sensor and battery case

Autonomy package with lithium battery SUPER B Epsilon, 12 V / 150 Ah

Pre wiring for autonomy package including charge controller with booster, battery sensor and battery case

Carbon monoxide detector

Dual USB charging socket and children's bed lights including USB charging socket

Heating / air conditioning

Auxiliary electric heater TRUMA Ultraheat including CI-BUS

Underfloor heating up to model 540

Roof-mounted air conditioning unit DOMETIC FreshJet including CI-BUS, with heating function, without lighting,

2.2 KW

Pre wiring for roof-mounted air conditioning unit

Multimedia

Articulated TV bracket including required connections, without video cables (Cinch)
