

EXCELLENT EDITION 650 UMFE

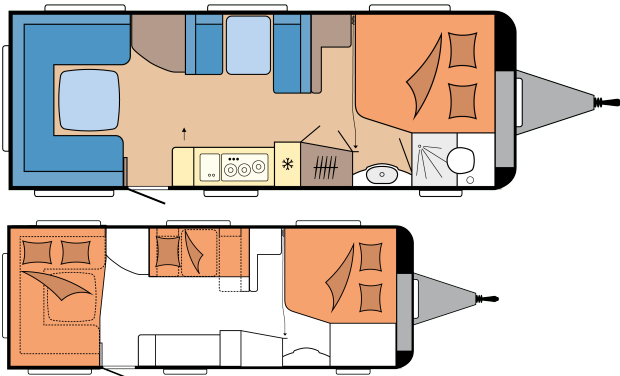

FLOORPLAN



Overall length	8.331 mm
Total width	2.500 mm
Technically permissible gross weight	1.900 kg

Note: The vehicles shown are model examples. Illustrations may vary.

TECHNICAL DATA *

Model	650 UMFe
Overall length	8.331 mm
Body length	7.168 mm
Overall width / Inside width	2.500 / 2.367 mm
Overall height / Interior headroom	2.628 / 1.950 mm
Maximum technically permissible laden mass	1.900 kg
Mass in running order (-/+5%)	1.659 (1.576-1.742) kg
Maximum mass for optional extras	36 kg
Technically possible increase in load capacity to	2.200 kg
Body wall thickness (floor / roof / wall)	39 / 31 / 31 mm
Awning circumference	10.920 mm
Beading (straight edge)	5.172 mm

Number of axles	2
Tyre size	155 / 80 R 13 XL
Number of berths (adults / children)	4 / 1
Bed size, double bed (length x width)	1.950 x 1.570 / 1.280 mm
Bed size, seating area bed conversion (length x width)	2.233 x 1.450; 1.800 x 835 mm
Autonomy package	Front centre
TV bracket	Sideboard
Fresh water tank; city water connection, optional	Rear right
External gas socket	Rear right
Locker door MAXI, THETFORD with central locking, 1,024 x 329 mm, lockable	Front left
Exterior awning socket	Rear right

HOBBYKOMPLETT

Chassis / Safety: Integrated 3rd brake light, Stabiliser hitch KNOTT, Overrun brake KNOTT ANS with automatic adjustment, Jockey wheel, Drawbar cover, One-key locking system, Rear fog light, Wheel shock absorbers, Heavy-duty supports, Licensed for up to 100 kph | Wheel Rims: Steel rims, silver with wheel covers | Windows: Front window with fully integrated pleated blackout blind and insect screen, Combi Cassette with pleated blind and fly screen, for all windows, Hinged window, can be opened, double-glazed and tinted | Body: Rooflight DOMETIC SEITZ, Midi-Heki 700 x 500 mm, with pleated blind and fly screen in living area, Rooflight DOMETIC SEITZ, Mini-Heki 400 x 400 mm, with pleated blind and fly screen in sleeping area, One-piece entrance door, extra wide with triple-point locking, window, waste bin, compartments and pleated insect screen in door frame, design dependent on model, Grab handle, Entrance step, Gas locker, accommodates 2 x 11 kg bottles, Integrated awning rail, LED awning light, Wheel arches, thermally insulated, Awning rail rain deflector with water drainage, front / rear, Wheel arch guard with rubber lip for draught skirt, Locker door MAXI, THETFORD with central locking, 1,024 x 329 mm, lockable, Winter vents for seating area, lockers and beds | Living area: Hook-on table, Single-post lift table, Wall units with plenty of storage space and soft-close doors, Wardrobe with interior light, Compartment under seating area, TV unit with illuminated cabinet | Furniture finish: Cape Town / White Matt / Grey | Upholstery combinations: Santo |

Kitchen: Refrigerator DOMETIC, 133 litres, 10 series, including 12-litre freezer compartment, double-hinged, absorption technology, Cooker and sink in stainless steel with 3-burner hob, electric ignition and split glass cover, Cutlery insert, Spice racks, Towel rail, Kitchen splashback with fully integrated blackout blind and insect screen, kitchen light, 230 V power sockets and USB charging socket, Kitchen light and separate power sockets, Drawers, generously sized, fully extendable, with soft-close and push lock mechanisms | Sleeping area: Double bed, Bed lift for slatted frame with gas spring for double beds and queen-size beds, Sprung mattresses on single, double and queen-size beds | Washroom: Compact washroom with integrated shower tray and external washbasin, Cassette toilet THETFORD, Hinged window with frosted glass look, can be opened, Blackout blind including insect screen for washroom | Water / gas / electricity: Waste water tank, 23.5 litres, rollable, Fresh water tank, 47 litres, Submersible pump, Gas regulator with over-pressure protection (DIN EN 12 864) and hose line, Gas control taps in kitchen unit, Control panel for lighting system and tank display, Light switch for children, Electronically controlled 12 V / 350 VA power supply, Ground fault circuit breaker, Exterior awning socket, including 230 V output, satellite / TV connection, Antenna socket with co-axial cable, Passenger vehicle connector JAEGER, 13-pole, Smoke alarm | LED lighting: Ambient lighting, design dependent on model, Corner shelves with lighting in seating area, design dependent on model,

Reading lights that change colour, can be dimmed in three stages, in seating area, Reading lights in seating area, Reading lights in sleeping area | Heating / air conditioning: Heating system TRUMA Combi 6 including 10-litre hot water supply system and frost monitor valve, Pre wiring for roof-mounted air conditioning unit | Smart Home: HOBBY CONNECT, controls for on-board technology via Hobby control panel and Bluetooth using app |

OPTIONAL EXTRAS

Chassis / Safety

Spare wheel with holder, underfloor mounting	28,2 kg
Stabilisation system KNOTT ETS Plus	5,7 kg

Increase / decrease in load capacity

Increase in load capacity to 2,000 kg, with technical modification for tandem-axle vehicles, from model 620	8 kg
Increase in load capacity to 2,200 kg, with technical modification for tandem-axle vehicles, from model 620	8 kg

Wheel Rims

Alloy rims silver, from model 620	
Alloy rims black, polished, from model 620	

Body

Bicycle rack THULE, for drawbar, 2 bicycles, loading capacity 60 kg	10 kg
---	-------

Living area

Carpet in the living area, removable	10 kg
--------------------------------------	-------

Upholstery combinations

Pico	
------	--

Kitchen

Oven THETFORD with electric ignition, grill and interior light, 36 litres	15 kg
Extractor hood DOMETIC including Hobby 10-stage speed control	3 kg

Sleeping area

Cold foam mattress, with comfortzones and slatted bed base for double bed and queen-size bed	2,9 kg
--	--------

Washroom

Shower fitting and shower curtain for washroom with external washbasin	2,8 kg
Clothes rail in the shower	0,5 kg

Water / gas / electricity

City water connection	0,5 kg
Gas pressure regulator TRUMA DuoControl including automatic changeover, crash sensor and gas filter	2,2 kg
Smart Trailer System (vehicle levelling and fuel level indicator via E-Trailer app)	0,8 kg
External gas socket	1,5 kg
Water pump with additional switch	0,4 kg
Autonomy package including charge controller with booster, battery (AGM, 95 Ah), battery sensor and battery case	29 kg
Autonomy package with lithium battery SUPER B Epsilon, 12 V / 150 Ah	19,1 kg
Pre wiring for autonomy package including charge controller with booster, battery sensor and battery case	2,8 kg
Dual USB charging socket	0,1 kg

Heating / air conditioning

Heating system TRUMA Combi 6 E, instead of Combi 6	1,1 kg
Underfloor heating from model 545	6 kg
Hot water heater ALDE COMPACT 3030 HE including CI-BUS	43 kg
Hot water underfloor heating for hot water heater ALDE	35 kg

Multimedia

Articulated TV bracket including required connections	2 kg
---	------

* Please note the following when consulting the technical details: The maximum technically permissible laden mass is the gross vehicle weight specified by the manufacturer, which must not be exceeded under any circumstances while driving the vehicle. In general, the "mass in running order" corresponds to the weight of the standard, empty vehicle in accordance with the manufacturer's specifications, and in the case of motorhomes and vans, includes the fuel tank filled to at least 90%, the mass of the driver (which is calculated at 75 kg), the fuel and liquids as well as the mass of the body, the cab, the trailer hitch (if fitted as standard) and the tyre repair set. For caravans, the mass in running order includes the mass of the vehicle equipped with standard equipment in accordance with the manufacturer's specifications, including fluids and the mass of the body, additional trailer hitches (if fitted as standard) and the tyre repair set. This is a calculated value, which is subject to legally permissible tolerances of up to $\pm 5\%$ (see note in brackets). Since the occurrence of legally permissible tolerances has a direct impact on the remaining loading capacity, these tolerances must be taken into account when configuring the vehicle. The maximum mass for optional extras is a value calculated for each layout that HOBBY uses to limit the available mass for optional extras that can be ordered and fitted at the factory. The aim of this value is to ensure that the legally prescribed minimum loading capacity is observed. If selecting optional extras increases the actual vehicle mass to such an extent that there is no longer sufficient available mass between the actual vehicle mass and the maximum technically permissible laden mass for the passengers (only with motorhomes and vans) and the minimum loading capacity, depending on the layout, you can choose to increase the load capacity of the vehicle (increase the maximum technically permissible laden mass) during the configuration. Alternatively, you can reduce the permitted number of people while driving (only for motorhomes and vans) and/or deselect optional extras. Otherwise, you will be unable to continue configuring the vehicle or proceed with the ordering process. For motorhomes and vans, the maximum number of permitted people while in transit specified in each case is dependent on the weight and axle load. It may be reduced when optional extras and accessories are installed, in which case individual seats must be removed to ensure the legally prescribed minimum loading capacity is observed. A weight of 75 kg is calculated for each person travelling, regardless of how much the passengers actually weigh. Since the driver is already included in the mass in running order, he/she is not included in the mass of the passengers. The capacity of the fresh water tank is reduced while taking into account the driving restriction (valve on the fresh water tank).



All information on variants, prices and weights can be found on our homepage.