

# EXCELLENT 560 CFE

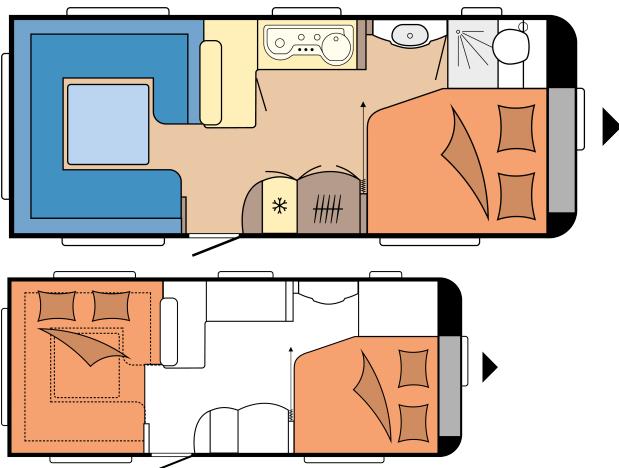

Overall length	7.510 mm
Total width	2.500 mm
Technically permissible gross weight	1.600 kg

## TECHNICAL DATA

Model	560 CFe
Number of axles	1
Tyre size	185 R 14 C
Overall length	7.510 mm
Body length	6.344 mm
Overall width / Inside width	2.500 / 2.367 mm
Overall height / Interior headroom	2.641 / 1.950 mm
Maximum technically permissible laden mass	1.600 kg
Mass in running order	1.464 kg
Payload	136 kg
Technically possible increase in load capacity to	2.000 kg
Payload after maximum increase in load capacity	503 kg
Body wall thickness (floor / roof / wall)	39 / 31 / 31 mm

Awning circumference	10.120 mm
Number of berths (adults / children)	4
Bed size, double bed (length x width)	1.950 x 1.570 / 1.280 mm
Bed size, seating area bed conversion (length x width)	2.233 x 2.050 / 1.650 mm
Autonomy package	Front centre
Roof-mounted air conditioning unit	Rear
TV bracket	Sideboard
Fresh water tank; city water connection, optional	Rear right
External gas socket	Rear right
Exterior awning socket	Rear right
Locker door MAXI, THETFORD with central locking, 1000 x 300 mm, lockable	Front right
Locker door THETFORD with central locking, 752 x 310 mm, lockable (optional)	Rear left
Number of 230 V power sockets (single / double)	4 / 2

## HOBBYKOMPLETT

**Furniture finish:** Olmo Pavarotti / Magnolia | **Upholstery combinations:** Stilo | **Chassis / Safety:** Stabiliser hitch KNOTT, Stabiliser hitch KNOTT, Overrun brake KNOTT ANS with automatic adjustment, Jockey wheel, Drawbar cover, One-key locking system, Integrated 3rd brake light, Rear fog light, Wheel shock absorbers, Tyre repair set, Heavy-duty supports, Load indicator on the jockey wheel, Licensed for up to 100 kph | **Living area:** Wall units MAXI, with plenty of storage space and soft-close doors, Set of Hobby glasses, Single-post lift table, Wardrobe with interior light, Wall units with plenty of storage space and soft-close doors | **Wheel Rims:** Steel rims, silver with wheel covers | **Windows:** Hinged window, can be opened, double-glazed and tinted, Front window with fully integrated pleated blackout blind and insect screen, Combi Cassette with pleated blind and fly screen, for all windows (excluding washroom) | **Body:** Rooflight DOMETIC SEITZ, Midi-Heki 700 x 500 mm, with pleated blind and fly screen in living area, Rooflight DOMETIC SEITZ, Mini-Heki 400 x 400 mm, with pleated blind and fly screen in sleeping area, One-

**Living area:** Compartment under seating area, TV unit with illuminated cabinet | **Kitchen:** Super Slim Tower refrigerator DOMETIC, 150 litres, including removable 15-litre freezer compartment, Stainless steel hob / sink combination with 3-burner hob, electric ignition and split glass cover, Corner base cabinet with swivel pull-out, Spice racks in kitchen wall unit, Drawers, generously sized, fully extendable, with soft-close and push lock mechanisms, Kitchen splashback with fully integrated blackout blind and insect screen, kitchen light, 230 V power sockets and USB charging socket, Cutlery insert, Towel rail | **Sleeping area:** Double bed, Sprung mattresses on single, double and queen-size beds, Bed lift for slatted frame with gas spring for double beds and queen-size beds | **Washroom:** Compact washroom with integrated shower tray and external washbasin, Cassette toilet THETFORD, Hinged window with frosted glass look, can be opened | **LED lighting:** Ambient lighting, design dependent on model, Corner shelves with lighting in seating area, design dependent on model, Reading lights that change colour, can be

piece entrance door, extra wide with triple-point locking, window, waste bin, compartments and pleated insect screen in door frame, design dependent on model, Grab handle, Entrance step, Integrated awning rail, Awning rail rain deflector with water drainage, front / rear, Wheel arches, thermally insulated, Wheel arch guard with rubber lip for draught skirt, LED awning light, Gas locker, accommodates 2 x 11 kg bottles, Locker door MAXI, THETFORD with central locking, 1,000 x 300 mm, lockable |

dimmed in three stages, in seating area, Swan neck lamps in sleeping area | **Heating / air conditioning:** Heating system TRUMA S-5004 with warm air unit and 12 V fan, Boiler TRUMA for hot water supply, Winter vents for seating area, lockers and beds | **Water / gas / electricity:** Waste water tank, 23.5 litres, rollable, Fresh water tank, 47 litres, Submersible pump, Gas regulator with over-pressure protection (DIN EN 12 864) and hose line, Gas control taps in kitchen unit, Control panel for lighting system and tank display, Light switch for children, Electronically controlled 12 V / 350 VA power supply, Ground fault circuit breaker, Exterior awning socket, including 230 V output, satellite / TV connection, Antenna socket with co-axial cable in living area, Passenger vehicle connector JAEGER, 13-pole, Smoke alarm |

## Upholstery combinations

Sari

Stilo including rose/grey decorative set	1,3 kg
------------------------------------------	--------

Sari including rose/grey decorative set	1,3 kg
-----------------------------------------	--------

## Body

Roof awning THULE OMNISTOR 6300, width 400 cm, pull-out depth 250 cm	33 kg
----------------------------------------------------------------------	-------

Rear lights with dynamic indicator	1 kg
------------------------------------	------

Bicycle rack THULE, for drawbar, 2 bicycles, loading capacity 60 kg	10 kg
---------------------------------------------------------------------	-------

Bicycle rack THULE, for rear, 2 bicycles, loading capacity 40 kg	7,5 kg
------------------------------------------------------------------	--------

Locker door THETFORD with central locking, 752 x 310 mm, lockable (optional)	0,5 kg
------------------------------------------------------------------------------	--------

## Kitchen

Microwave, 20 litres and extractor hood DOMETIC	18 kg
-------------------------------------------------	-------

Oven THETFORD with electric ignition, grill and interior light, 36 litres	15 kg
---------------------------------------------------------------------------	-------

Extractor hood DOMETIC including Hobby 10-stage speed control	3 kg
---------------------------------------------------------------	------

## Water / gas / electricity

Carbon monoxide detector	0,5 kg
--------------------------	--------

Gas pressure regulator TRUMA DuoControl including automatic changeover, crash sensor and gas filter	2,2 kg
-----------------------------------------------------------------------------------------------------	--------

Adapter 7/13-pole for passenger vehicle connecting cable	0,3 kg
----------------------------------------------------------	--------

City water connection	0,5 kg
-----------------------	--------

External gas socket	1,5 kg
---------------------	--------

Electric boiler TRUMA, 14 litres (locker door can be removed)	15 kg
---------------------------------------------------------------	-------

Water pump with additional switch	0,4 kg
-----------------------------------	--------

Autonomy package including charge controller with booster, battery, battery sensor and battery case	29 kg
-----------------------------------------------------------------------------------------------------	-------

Pre wiring for autonomy package including charge controller with booster, battery sensor and battery case	2,8 kg
Wireless remote control for the lighting system with one handset	0,3 kg
Dual USB charging socket	

### Smart Home

HOBBY CONNECT, controls for on-board technology via TFT control panel and Bluetooth using app	0,1 kg
HOBBY-CONNECT+, remote control for on-board technology via mobile communications using app	0,6 kg

### Chassis / Safety

Hitch lock anti-theft device KNOTT "KS 25"	0,3 kg
Spare wheel with holder, instead of tyre repair set, underfloor mounting	26 kg
Stabilisation system KNOTT ETS Plus	5,7 kg

### Wheel Rims

Alloy rims silver, up to model 560	
Alloy rims black, polished, up to model 560	

### Living area

Carpet in the living area, removable	10 kg
--------------------------------------	-------

### Sleeping area

Cold foam mattress, with 7 zones and slatted bed base for double bed and queen-size bed	2,9 kg
Bedspread	1,5 kg

### Washroom

Shower fitting and shower curtain for washroom with external washbasin	2,8 kg
Blackout blind including insect screen for washroom	1,5 kg
Clothes rail in the shower	0,5 kg

### Heating / air conditioning

Auxiliary electric heater TRUMA Ultraheat including CI-BUS	2 kg
Underfloor heating from model 545	6 kg
Hot water heater ALDE COMPACT 3020 HE including CI-BUS	41,5 kg
Roof-mounted air conditioning unit DOMETIC FreshJet including CI-BUS, with heating function, without lighting, 2.2 KW	32 kg
Pre wiring for roof-mounted air conditioning unit	1,5 kg

### Multimedia

Articulated TV bracket including required connections, without video cables (Cinch)	2 kg
TV aerial mast TELECO	0,9 kg