

EXCELLENT 560 WFU

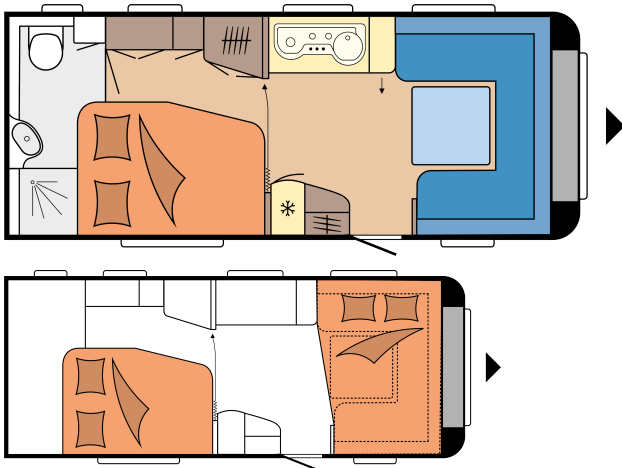

Overall length	7.558 mm
Total width	2.500 mm
Technically permissible gross weight	1.600 kg

TECHNICAL DATA

Model	560 WFU	Awning circumference	10.160 mm
Number of axles	1	Number of berths (adults / children)	4
Tyre size	185 R 14 C	Bed size, double bed (length x width)	1.985 x 1.385 / 1.150 mm
Overall length	7.558 mm	Bed size, seating area bed conversion (length x width)	2.233 x 1.600 / 1.300 mm
Body length	6.392 mm	Autonomy package	Front left
Overall width / Inside width	2.500 / 2.367 mm	Roof-mounted air conditioning unit	Centre
Overall height / Interior headroom	2.636 / 1.950 mm	TV bracket	Sideboard
Maximum technically permissible laden mass	1.600 kg	Fresh water tank; city water connection, optional	Front right
Mass in running order	1.467 kg	External gas socket	Front right
Payload	133 kg	Exterior awning socket	Front right
Technically possible increase in load capacity to	2.000 kg	Locker door MAXI, THETFORD with central locking, 1000 x 300 mm, lockable	Rear right
Payload after maximum increase in load capacity	500 kg	Number of 230 V power sockets (single / double)	4 / 3
Body wall thickness (floor / roof / wall)	39 / 31 / 31 mm		

HOBBYKOMPLETT

Furniture finish: Olmo Pavarotti / Magnolia | **Upholstery combinations:** Stilo | **Smart Home:** HOBBY CONNECT, controls for on-board technology via TFT control panel and Bluetooth using app | **Chassis / Safety:** Stabiliser hitch KNOTT, Stabiliser hitch KNOTT, Overrun brake KNOTT ANS with automatic adjustment, Jockey wheel, Drawbar cover, One-key locking system, Integrated 3rd brake light, Rear fog light, Wheel shock absorbers, Tyre repair set, Heavy-duty supports, Load indicator on the jockey wheel, Licensed for up to 100 kph | **Living area:** Wall units MAXI, with plenty of storage space and soft-close doors, Metal lift table | **Wheel Rims:** Steel rims, silver with wheel covers | **Windows:** Hinged window, can be opened, double-glazed and tinted, Panoramic front window with fully integrated blackout blind and insect screen, Combi Cassette with pleated blind and fly screen, for all windows (excluding washroom) | **Body:** Rooflight DOMETIC SEITZ, Midi-Heki 700 x 500 mm, with pleated blind and fly screen in living area, Rooflight DOMETIC SEITZ, Mini-Heki 400 x 400 mm, with pleated blind and fly screen in sleeping area, Rooflight DOMETIC SEITZ, Mini-Heki 400 x 400 mm, with pleated blind and fly screen in washroom, One-piece entrance door, extra wide with triple-point locking, window, waste bin, compartments and pleated insect screen in door frame, design dependent on

Living area: Heated coat rack in entrance area, Wardrobe with interior light, Wall units with plenty of storage space and soft-close doors, Compartment under seating area, TV unit with illuminated cabinet | **Kitchen:** Super Slim Tower refrigerator DOMETIC, 150 litres, including removable 15-litre freezer compartment, Stainless steel hob / sink combination with 3-burner hob, electric ignition and split glass cover, Spice racks in kitchen wall unit, Drawers, generously sized, fully extendable, with soft-close and push lock mechanisms, Kitchen splashback with fully integrated blackout blind and insect screen, kitchen light, 230 V power sockets and USB charging socket, Cutlery insert, Towel rail | **Sleeping area:** Double bed, Sprung mattresses on single, double and queen-size beds, Bed lift for slatted frame with gas spring for double beds and queen-size beds | **Washroom:** Rear washroom with separate shower cubicle, design dependent on model, Swivel toilet THETFORD, Hinged window with frosted glass look, can be opened | **LED lighting:** Ambient lighting, design dependent on model, Swan neck lamps in seating area, Swan neck lamps in sleeping area | **Heating / air conditioning:** Heating system TRUMA Combi 6 including 10-litre hot water supply system and frost monitor valve, Winter vents for seating area, lockers and beds | **Water / gas / electricity:** Waste water tank, 23.5 litres, rollable,

model, Grab handle, Entrance step, Integrated awning rail, Awning rail rain deflector with water drainage, front / rear, Wheel arches, thermally insulated, Wheel arch guard with rubber lip for draught skirt, LED awning light, Gas locker, accommodates 2 x 11 kg bottles, Locker door MAXI, THETFORD with central locking, 1,000 x 300 mm, lockable |

Fresh water tank, 47 litres, Submersible pump, Gas regulator with over-pressure protection (DIN EN 12 864) and hose line, Gas control taps in kitchen unit, Light switch for children, Electronically controlled 12 V / 350 VA power supply, Ground fault circuit breaker, Exterior awning socket, including 230 V output, satellite / TV connection, Antenna socket with co-axial cable in living area, Passenger vehicle connector JAEGER, 13-pole, Smoke alarm |

Upholstery combinations

Sari	
Stilo including rose/grey decorative set	1,3 kg
Sari including rose/grey decorative set	1,3 kg

Body

Roof awning THULE OMNISTOR 6300, width 400 cm, pull-out depth 250 cm	33 kg
Rear lights with dynamic indicator	1 kg
Bicycle rack THULE, for drawbar, 2 bicycles, loading capacity 60 kg	10 kg
Bicycle rack THULE, for rear, 2 bicycles, loading capacity 40 kg	7,5 kg

Kitchen

Microwave, 20 litres and extractor hood DOMETIC	18 kg
Oven THETFORD with electric ignition, grill and interior light, 36 litres	15 kg
Extractor hood DOMETIC including Hobby 10-stage speed control	3 kg

Water / gas / electricity

Carbon monoxide detector	0,5 kg
Gas pressure regulator TRUMA DuoControl including automatic changeover, crash sensor and gas filter	2,2 kg
Adapter 7/13-pole for passenger vehicle connecting cable	0,3 kg
City water connection	0,5 kg
External gas socket	1,5 kg
Water pump with additional switch	0,4 kg
Autonomy package including charge controller with booster, battery, battery sensor and battery case	29 kg
Pre wiring for autonomy package including charge controller with booster, battery sensor and battery case	2,8 kg
Dual USB charging socket	

Chassis / Safety

Hitch lock anti-theft device KNOTT "KS 25"	0,3 kg
Spare wheel with holder, instead of tyre repair set, underfloor mounting	26 kg

Stabilisation system KNOTT ETS Plus	5,7 kg
-------------------------------------	--------

Wheel Rims

Alloy rims silver, up to model 560	
------------------------------------	--

Alloy rims black, polished, up to model 560	
---	--

Living area

Single-post lift table	8 kg
------------------------	------

Carpet in the living area, removable	10 kg
--------------------------------------	-------

Sleeping area

Cold foam mattress, with 7 zones and slatted bed base for double bed and queen-size bed	2,9 kg
---	--------

Bedsread	1,5 kg
----------	--------

Washroom

Blackout blind including insect screen for washroom	1,5 kg
---	--------

Smart Home

HOBBY-CONNECT+, remote control for on-board technology via mobile communications using app	0,6 kg
--	--------

Heating / air conditioning

Heating system TRUMA Combi 6 E, instead of Combi 6	1,1 kg
--	--------

Underfloor heating from model 545	6 kg
-----------------------------------	------

Hot water heater ALDE COMPACT 3020 HE including CI-BUS	41,5 kg
--	---------

Roof-mounted air conditioning unit DOMETIC FreshJet including CI-BUS, with heating function, without lighting, 2.2 KW	32 kg
--	-------

Pre wiring for roof-mounted air conditioning unit	1,5 kg
---	--------

Multimedia

Articulated TV bracket including required connections, without video cables (Cinch)	2 kg
---	------

TV aerial mast TELECO	0,9 kg
-----------------------	--------