

# PREMIUM 560 UL

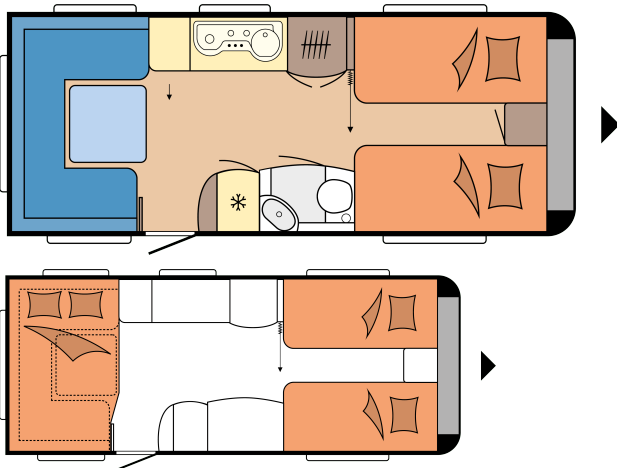

|                                      |          |
|--------------------------------------|----------|
| Overall length                       | 8.013 mm |
| Total width                          | 2.500 mm |
| Technically permissible gross weight | 1.800 kg |

## TECHNICAL DATA

|   |                  |  |                             |
|---|------------------|--|-----------------------------|
| Model   | 560 UL           | Awning circumference   | 9.930 mm                    |
| Number of axles                                   | 1                | Number of berths (adults / children)   | 4                           |
| Tyre size   | 195 R 14 C       | Bed size, single beds (length x width)                                       | 1.975 x 890; 1.955 x 890 mm |
| Overall length                                    | 8.013 mm         | Bed size, seating area bed conversion (length x width)                       | 2.233 x 1.427 / 1.344 mm    |
| Body length                                       | 6.843 mm         | Autonomy package   | Front right                 |
| Overall width / Inside width                      | 2.500 / 2.367 mm | Roof-mounted air conditioning unit   | Centre                      |
| Overall height / Interior headroom                | 2.649 / 1.950 mm | TV bracket   | Sideboard                   |
| Maximum technically permissible laden mass        | 1.800 kg         | Fresh water tank; city water connection, optional                            | Rear right                  |
| Mass in running order                             | 1.599 kg         | External gas socket  | Front right                 |
| Payload   | 201 kg           | Exterior awning socket   | Rear right                  |
| Technically possible increase in load capacity to | 2.000 kg         | Locker door MAXI, THETFORD with central locking, 1000 x 300 mm, lockable     | Front right                 |
| Payload after maximum increase in load capacity   | 387 kg           | Locker door THETFORD with central locking, 752 x 310 mm, lockable (optional) | Rear left / Front left      |
| Technically possible decrease in load capacity to | 1.750 kg         | Number of 230 V power sockets (single / double)                              | 3 / 3                       |
| Body wall thickness (floor / roof / wall)         | 39 / 31 / 31 mm  |  |                             |

## HOBBYKOMPLETT

**Smart Home:** HOBBY CONNECT, controls for on-board technology via TFT control panel and Bluetooth using app | **Chassis / Safety:** Stabiliser hitch KNOTT, Overrun brake KNOTT ANS with automatic adjustment, Jockey wheel, Drawbar cover, One-key locking system, Integrated 3rd brake light, Rear fog light, Wheel shock absorbers, Tyre repair set, Heavy-duty supports, Load indicator on the jockey wheel, Licensed for up to 100 kph | **Living area:** Wall units MAXI, with plenty of storage space and soft-close doors, Set of Hobby glasses, Single-post lift table, Wardrobe with interior light | **Body:** Rooflight DOMETIC SEITZ, Micro-Heki 280 x 280 mm, with pleated blind and fly screen in washroom, Rooflight DOMETIC SEITZ, Midi-Heki 700 x 500 mm, with pleated blind and fly screen in living area, Rooflight DOMETIC SEITZ, Mini-Heki 400 x 400 mm, with pleated blind and fly screen in sleeping area, One-piece entrance door, extra wide with triple-point locking, window, waste bin, compartments and pleated insect screen in door frame, design dependent on model, Grab handle, Entrance step, Integrated awning rail, Awning rail rain deflector with water

**Living area:** Wall units with plenty of storage space and soft-close doors, Compartment under seating area, TV unit with illuminated cabinet | **Furniture finish:** Bronze, Stone Grey, Magnolia Metallic | **Upholstery combinations:** Kentucky | **Kitchen:** Super Slim Tower refrigerator DOMETIC, 150 litres, including removable 15-litre freezer compartment, Stainless steel hob / sink combination with 3-burner hob, electric ignition and split glass cover, Spice racks in kitchen wall unit, Drawers, generously sized, fully extendable, with soft-close and push lock mechanisms, Kitchen splashback with fully integrated blackout blind and insect screen, kitchen light, 230 V power sockets and USB charging socket, Cutlery insert, Towel rail | **Sleeping area:** Single beds, Sprung mattresses on single, double and queen-size beds, Bed lift for slatted frame on single beds, mechanical | **Washroom:** Compact washroom with washbasin and toilet, design dependent on model, Cassette toilet THETFORD | **LED lighting:** Ambient lighting, design dependent on model, Corner shelves with lighting in seating area, design dependent on model, Swan neck lamps in sleeping area | **Heating / air**

drainage, front / rear, Wheel arches, thermally insulated, Wheel arch guard with rubber lip for draught skirt, LED awning light, Gas locker, accommodates 2 x 11 kg bottles, Boot in rear, Locker door MAXI, THETFORD with central locking, 1,000 x 300 mm, lockable | **Wheel Rims:** Alloy rims black, polished, up to model 560 | **Windows:** Hinged window, can be opened, double-glazed and tinted, Combi Cassette with pleated blind and fly screen, for all windows (excluding washroom) |

**conditioning:** Heating system TRUMA S-5004 with warm air unit and 12 V fan, Boiler TRUMA for hot water supply, Winter vents for seating area, lockers and beds | **Water / gas / electricity:** Waste water tank, 23.5 litres, rollable, Fresh water tank, 47 litres, Submersible pump, Gas regulator with over-pressure protection (DIN EN 12 864) and hose line, Gas control taps in kitchen unit, Light switch for children, Electronically controlled 12 V / 350 VA power supply, Ground fault circuit breaker, Exterior awning socket, including 230 V output, satellite / TV connection, Antenna socket with co-axial cable in living area, Passenger vehicle connector JAEGER, 13-pole, Smoke alarm |

---

## Body

|  |        |
|--|--------|
| Roof awning THULE OMNISTOR 6300, width 400 cm, pull-out depth 250 cm         | 33 kg  |
| Bicycle rack THULE, for drawbar, 2 bicycles, loading capacity 60 kg          | 10 kg  |
| Locker door THETFORD with central locking, 752 x 310 mm, lockable (optional) | 0,5 kg |

## Kitchen

|   |       |
|---|-------|
| Microwave, 20 litres and extractor hood DOMETIC                           | 18 kg |
| Oven THETFORD with electric ignition, grill and interior light, 36 litres | 15 kg |
| Extractor hood DOMETIC including Hobby 10-stage speed control             | 3 kg  |

## Chassis / Safety

|  |        |
|--|--------|
| Hitch lock anti-theft device KNOTT "KS 25"                               | 0,3 kg |
| Alloy spare wheel black polished with holder, instead of tyre repair set | 26 kg  |
| Stabilisation system KNOTT ETS Plus                                      | 5,7 kg |

## Water / gas / electricity

|   |        |
|---|--------|
| Carbon monoxide detector  | 0,5 kg |
| Adapter 7/13-pole for passenger vehicle connecting cable  | 0,3 kg |
| City water connection   | 0,5 kg |
| External gas socket   | 1,5 kg |
| Electric boiler TRUMA, 14 litres (locker door can be removed)   | 15 kg  |
| Water pump with additional switch   | 0,4 kg |
| Autonomy package including charge controller with booster, battery, battery sensor and battery case       | 29 kg  |
| Pre wiring for autonomy package including charge controller with booster, battery sensor and battery case | 2,8 kg |
| Dual USB charging socket  |        |

## Living area

|                                      |       |
|--------------------------------------|-------|
| Carpet in the living area, removable | 10 kg |
|--------------------------------------|-------|

## Sleeping area

|   |        |
|---|--------|
| Bed extension for single beds including cushion                         | 5 kg   |
| Cold foam mattresses, with 7 zones and slatted bed base for single beds | 2,9 kg |
| Bedspread   | 1,5 kg |

## Smart Home

|  |        |
|--|--------|
| HOBBY-CONNECT+, remote control for on-board technology via mobile communications using app | 0,6 kg |
|--|--------|

## Heating / air conditioning

|   |         |
|---|---------|
| Auxiliary electric heater TRUMA Ultraheat including CI-BUS  | 2 kg    |
| Underfloor heating from model 545   | 6 kg    |
| Hot water heater ALDE COMPACT 3020 HE including CI-BUS  | 41,5 kg |
| Roof-mounted air conditioning unit DOMETIC FreshJet including CI-BUS, with heating function, without lighting, 2.2 KW | 32 kg   |
| Pre wiring for roof-mounted air conditioning unit   | 1,5 kg  |

## Multimedia

|   |        |
|---|--------|
| Articulated TV bracket including required connections, without video cables (Cinch) | 2 kg   |
| TV aerial mast TELECO   | 0,9 kg |