

# PREMIUM 650 UFF

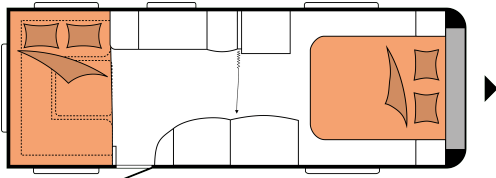
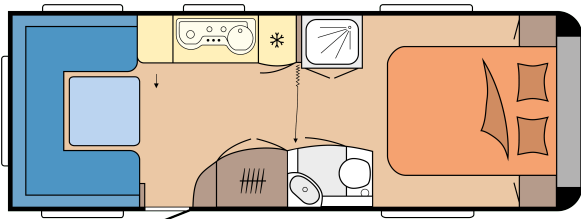

Overall length	8.828 mm
Total width	2.500 mm
Technically permissible gross weight	2.000 kg

## TECHNICAL DATA

Model	650 UFF	Body wall thickness (floor / roof / wall)	39 / 31 / 31 mm
Number of axles	2	Awning circumference	10.920 mm
Tyre size	165 R 13 C	Number of berths (adults / children)	4
Overall length	8.828 mm	Bed size, queen-size bed (length x width)	2.000 x 1.560 mm
Body length	7.655 mm	Bed size, seating area bed conversion (length x width)	2.233 x 1.481 / 1.452 mm
Overall width / Inside width	2.500 / 2.367 mm	Autonomy package	Rear centre
Overall height / Interior headroom	2.642 / 1.950 mm	Roof-mounted air conditioning unit	Rear
Maximum technically permissible laden mass	2.000 kg	TV bracket	Sideboard
Mass in running order	1.703 kg	Fresh water tank; city water connection, optional	Rear right
Payload	298 kg	External gas socket	Rear right
Technically possible increase in load capacity to	2.200 kg	Exterior awning socket	Rear right
Payload after maximum increase in load capacity	497 kg	Number of 230 V power sockets (single / double)	5 / 2
Technically possible decrease in load capacity to	1.900 kg		

## HOBBYKOMPLETT

**Smart Home:** HOBBY CONNECT, controls for on-board technology via TFT control panel and Bluetooth using app | **Chassis / Safety:** Stabiliser hitch KNOTT, Overrun brake KNOTT ANS with automatic adjustment, Jockey wheel, Drawbar cover, One-key locking system, Integrated 3rd brake light, Rear fog light, Wheel shock absorbers, Heavy-duty supports, Licensed for up to 100 kph | **Living area:** Wall units MAXI, with plenty of storage space and soft-close doors, Set of Hobby glasses, Single-post lift table, Wardrobe with interior light, Wall units with plenty of storage space and soft-close doors | **Body:** Rooflight DOMETIC SEITZ, Micro-Heki 280 x 280 mm, with pleated blind and fly screen in washroom, Rooflight DOMETIC SEITZ, Midi-Heki 700 x 500 mm, with pleated blind and fly screen in living area, Rooflight DOMETIC SEITZ, Mini-Heki 400 x 400 mm, with pleated blind and fly screen in sleeping area, One-piece entrance door, extra wide with triple-point locking, window, waste bin, compartments and pleated insect screen in door frame, design dependent on model, Grab handle, Entrance step, Integrated awning rail, Awning rail rain deflector with water drainage, front / rear, Wheel arches, thermally insulated, Wheel arch guard with rubber lip for draught skirt, LED awning light, Gas locker, accommodates 2 x 11 kg bottles, Boot in rear | **Wheel Rims:** Alloy rims black, polished, from model 620 |

**Living area:** Compartment under seating area, TV unit with illuminated cabinet | **Furniture finish:** Bronze, Stone Grey, Magnolia Metallic | **Upholstery combinations:** Kentucky | **Kitchen:** Super Slim Tower refrigerator DOMETIC, 150 litres, including removable 15-litre freezer compartment, Stainless steel hob / sink combination with 3-burner hob, electric ignition and split glass cover, Spice racks in kitchen wall unit, Drawers, generously sized, fully extendable, with soft-close and push lock mechanisms, Kitchen splashback with fully integrated blackout blind and insect screen, kitchen light, 230 V power sockets and USB charging socket, Cutlery insert, Towel rail | **Sleeping area:** Queen-size bed, Sprung mattresses on single, double and queen-size beds, Bed lift for slatted frame with gas spring for double beds and queen-size beds | **Washroom:** Open-plan washroom design with separate shower cubicle, design dependent on model, Cassette toilet THETFORD | **LED lighting:** Ambient lighting, design dependent on model, Corner shelves with lighting in seating area, design dependent on model, Swan neck lamps in sleeping area | **Heating / air conditioning:** Heating system TRUMA Combi 6 including 10-litre hot water supply system and frost monitor valve, Winter vents for seating area, lockers and beds | **Water / gas / electricity:** Waste water tank, 23.5 litres, rollable, Fresh water

**Windows:** Hinged window, can be opened, double-glazed and tinted, Combi Cassette with pleated blind and fly screen, for all windows (excluding washroom) |

tank, 47 litres, Submersible pump, Gas regulator with over-pressure protection (DIN EN 12 864) and hose line, Gas control taps in kitchen unit, Light switch for children, Electronically controlled 12 V / 350 VA power supply, Ground fault circuit breaker, Exterior awning socket, including 230 V output, satellite / TV connection, Antenna socket with co-axial cable in living area, Passenger vehicle connector JAEGER, 13-pole, Smoke alarm |

---

## Body

Roof awning THULE OMNISTOR 6300, width 450 cm, pull-out depth 250 cm	35 kg
Bicycle rack THULE, for drawbar, 2 bicycles, loading capacity 60 kg	10 kg

## Kitchen

Microwave, 20 litres and extractor hood DOMETIC	18 kg
Oven THETFORD with electric ignition, grill and interior light, 36 litres	15 kg
Extractor hood DOMETIC including Hobby 10-stage speed control	3 kg

## Chassis / Safety

Hitch lock anti-theft device KNOTT "KS 25"	0,3 kg
Alloy spare wheel black polished with holder	28,2 kg
Load indicator on the jockey wheel	0,6 kg
Stabilisation system KNOTT ETS Plus	5,7 kg

## Water / gas / electricity

Carbon monoxide detector	0,5 kg
Adapter 7/13-pole for passenger vehicle connecting cable	0,3 kg
City water connection	0,5 kg
External gas socket	1,5 kg
Electric boiler TRUMA, 14 litres (locker door can be removed)	15 kg
Water pump with additional switch	0,4 kg
Autonomy package including charge controller with booster, battery, battery sensor and battery case	29 kg
Pre wiring for autonomy package including charge controller with booster, battery sensor and battery case	2,8 kg
Dual USB charging socket	

## Living area

Carpet in the living area, removable	10 kg
--------------------------------------	-------

## Sleeping area

---

Cold foam mattress, with 7 zones and slatted bed base for double bed and queen-size bed	2,9 kg
Bedspread	1,5 kg

### Smart Home

HOBBY-CONNECT+, remote control for on-board technology via mobile communications using app	0,6 kg
--	--------

### Heating / air conditioning

Heating system TRUMA Combi 6 E, instead of Combi 6	1,1 kg
Underfloor heating from model 545	6 kg
Hot water heater ALDE COMPACT 3020 HE including CI-BUS	41,5 kg
Roof-mounted air conditioning unit DOMETIC FreshJet including CI-BUS, with heating function, without lighting, 2.2 KW	32 kg
Pre wiring for roof-mounted air conditioning unit	1,5 kg

### Multimedia

Articulated TV bracket including required connections, without video cables (Cinch)	2 kg
TV aerial mast TELECO	0,9 kg