

ONTOUR T 710 GE

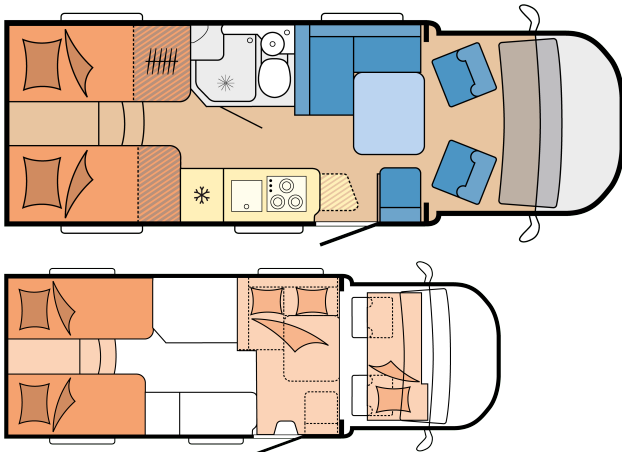

FLOORPLAN



Overall length	7.059 mm
Total width	2.400 mm
Technically permissible gross weight	3.500 kg

Note: The vehicles shown are model examples. Illustrations may vary.

TECHNICAL DATA *

Model	710 GE	Bed size, cab bed conversion (length x width)	1.600 x 740 mm
Number of axles	2	Fuel tank	90 l
Front wheel drive		AdBlue tank	19 l
Wheelbase	4.035 mm	Waste water tank	96 l
Tyre size	225 / 75 R 16 CP	Fresh water tank	10 / 100 l
Turning circle	14,43 m	External socket	Passenger side
Overall length	7.059 mm	Roof-mounted air conditioning unit	Centre / rear
Overall width	2.400 mm	TV bracket	Seating area / washroom
Overall height	2.883 mm	Fresh water tank	Bench seat / seatbelt anchor
Interior headroom	2.054 mm	External gas socket	Passenger side
Maximum technically permissible laden mass	3.500 kg	Additional power sockets, 1 x 12 V	Garage
Mass in running order (-/+5%)	3.095 (2.940-3.250) kg	Additional power sockets, 2 x 230 V	Sleeping area / garage
Maximum mass for optional extras	1 kg	Additional power sockets, 2 x USB-	Schlafbereich
Towing capacity, braked	2.000 kg	A/C	
Body wall thickness (floor / roof / wall)	42 / 34 / 34 mm	Gas bottle locker	2 x 11 kg
Number of people when driving	4	Number of power sockets (12 V / 230 V / USB)	1 / 4 / 1
Three-point seatbelts	4	Charger	25 A
Number of berths / optional berths	2 / 3	Charge booster	30 A
Bed size, single beds (length x width)	2.020 x 845; 1.900 x 845 mm	Garage internal dimensions (length x width x height)	1.000 x 2.180 x 1.100 mm
Bed size, seating area bed conversion (length x width)	2.120 x 1.190 mm	Garage door on passenger side (inner dimensions: width x height)	820 x 1.010 mm
		Garage door on driver's side (inner dimensions: width x height)	820 x 1.010 mm

HOBBYKOMPLETT

Chassis: FIAT Low-Frame Chassis Light, 3,500 kg | Engine: 2,184 ccm, 103 kW / 140 hp, Euro 6EA, with start / stop technology and ECO pack, 6-speed manual transmission | Increase in load capacity: Registration for 4 persons | Wheel Rims: 16" bicolour alloy rims | Base vehicle: Wing mirrors, electrically adjustable and heated, Halogen headlights with daytime running lights, Electric windows, "LOUNGE" pack (including electronic air conditioning with pollen filter, inductive smartphone charging function and digital instrument display as 7" TFT colour screen),

Body: Fly screen for habitation entrance door, Apron rails made of aluminium | Garages and lockers: Garage door on passenger side, Garage door on the driver's side, Lowered rear with XPS heat insulation, Rear garage, insulated and heated, with robust floor covering, Tie down rails and points in garage | Living area: Wall units with plenty of storage space, Wardrobe with interior light, L-shaped seating area with folding single-post lift table, can be rotated through 360°, design dependent on model, Smooth transition from cab to habitation area | Furniture

Hazard triangle and first aid kit, Central locking with remote control, All-weather M+S tyres, Wing mirrors, extended, On-board computer, Diesel fuel tank, 90 litres, Driver and passenger airbag, Painted bumpers including black skid plate, Radio antenna (DAB), Charge booster 30 A, Steering wheel with controls, Leather steering wheel and gearstick, dashboard with Techno trim, Fog lights with cornering light, Tyre repair set, Mud flaps, front, Immobiliser, electronic | Assistance systems: ABS anti-lock braking system, ESP including ASR, Hill Holder and intelligent traction control, "Safety" pack (including automatic braking system with pedestrian detection, rain and light sensor, lane departure warning system, traffic sign recognition, driver fatigue detection and intelligent speed assistant), Post-collision braking system, Crosswind Assist, Tyre pressure monitoring system, Cruise control incl. adaptive cruise control >30 km/h, Trailer Stability Assist | Design variants: Front end paint finish white | Cab: Cup holder, Roof vent, can be opened, double-glazed and tinted, Swivel driver and passenger seat, Driver and passenger seat covered in same upholstery as living area, Height-adjustable driver and passenger seats with armrests ("Captain's Chair") and lumbar support, All-round shelf, USB charging socket (USB-A/USB-C), Blackout system REMIS for front and side cab windows | Windows: Hinged window, can be opened, double-glazed and tinted, Hinged window, can be opened, double-glazed and tinted, on the driver's side in the sleeping area, Hinged window, can be opened, double-glazed and tinted, on the driver's side in the sleeping area, Hinged window, can be opened, double-glazed and tinted, on the driver's side in the sleeping area, 840 x 260 mm, Combi Cassette with pleated blind and fly screen, for all windows | Body: GRP roof for optimal hail protection, Awning THULE OMNISTOR, width 400 cm, pull-out depth 250 cm, Entrance door, extra wide with double lock, window, waste bin and compartments, inner dimensions: 605 x 1,740 mm, Grab handle, Entry step, electrically operated, Rooflight DOMETIC SEITZ, Mini-Heki 400 x 400 mm, with pleated blind and fly screen in sleeping area, Rooflight DOMETIC SEITZ, Mini-Heki 400 x 400 mm, with pleated blind and fly screen in washroom, Gas bottle pull-out shelf, accommodates 2 x 11 kg bottles, GRP floor with XPS heat insulation, Rooflight DOMETIC SEITZ, Midi-Heki 700 x 500 mm, with pleated blind and fly screen in living area, Reinforced rear for bicycle rack, LED entry light, Winter vents for seating area, lockers and beds |

finish: Kopenhagen / Piquet | Upholstery combinations: Cor | Kitchen: Refrigerator (AES) DOMETIC, 133 litres, double-hinged, absorption technology, Stainless steel 3-burner hob, electric ignition and glass cover, Worktop extension, Spice racks, Stainless steel sink with glass cover, Cutlery insert, Kitchen with generously-sized, fully-extendable drawers with soft-close mechanism, Kitchen power socket | Sleeping area: Light switch in sleeping area, Single beds, Bed extension including cold foam mattress and ladder, Cold foam mattress(es), Slatted frame system GOODSIDE®, All-round wall units above bed, Under-bed linen compartment | Washroom: Swivel toilet THETFORD, Shower screen, Shower column with shower fitting and compartments, Mirror cabinet, Washing line, extendable, Compact washroom with integrated shower | Water / gas / electricity: Waste water tank, 96 litres, insulated and heated, Fresh water tank, 10 / 100 litres, frost-protected, Frost-protected installation in the floor pedestal, Pre wiring for solar power system, Gas regulator with over-pressure protection (DIN EN 12 864) and hose line, Gas control taps in kitchen unit, AGM habitation battery, 12 V / 95 Ah, 1x dual USB charging socket (USB-A/USB-C) for living area, Smoke alarm, Power supply, 12 V / 230 V, Twin submersible pump | LED lighting: Work surface lighting in the kitchen, Garage lighting, Ceiling light in living and sleeping area, Reading lights in sleeping area, Reading lights in seating area, Pre wiring for ambient lighting | Heating / air conditioning: Heating system TRUMA Combi 6 including 10-litre hot water supply system and frost monitor valve, Control panel TRUMA CP Classic, Pre wiring for roof-mounted air conditioning unit, Hot water supply in kitchen and washroom | Smart Home: HOBBY CONNECT, controls for on-board technology via Hobby control panel and Bluetooth using app | Multimedia: PIONEER radio, 9" touchscreen including Apple CarPlay/Android Auto and reversing camera, TV connection, including 12 V / 230 V and antenna socket, Pre wired for satellite system |

OPTIONAL EXTRAS

Chassis

FIAT Low-Frame Chassis Maxi, 4,400 kg (only in conjunction with 180 hp engine)	40 kg
--	-------

Engine

2,184 ccm, 103 kW / 140 hp, Euro 6EA, with start / stop technology and ECO pack, 8-speed automatic transmission	18 kg
2,184 ccm, 132 kW / 180 hp, Euro 6EA, with start / stop technology and ECO pack, 8-speed automatic transmission	33 kg

(inclusive FIAT Low-Frame Chassis Maxi, 4,400 kg)

Increase in load capacity

Increase in load capacity to 3,650 kg, without any technical modifications

Reduction to two authorised seats

Reduction to three authorised seats

Base vehicle

Trailer hitch SAWIKO, detachable	29 kg
----------------------------------	-------

Cab

Floor mat in the cab	1,5 kg
----------------------	--------

Thermal curtains including footwell insulation	4,5 kg
--	--------

Body

Rear corner steadies	6 kg
----------------------	------

Living area

Carpet in the living area, removable	10 kg
--------------------------------------	-------

Upholstery combinations

Kos

Kitchen

Oven with electric ignition and light	16 kg
---------------------------------------	-------

Extractor hood DOMETIC	3 kg
------------------------	------

Sleeping area

Bed conversion for cab incl. cushion	10 kg
--------------------------------------	-------

Bed conversion for seating group incl. cushion	2 kg
--	------

Water / gas / electricity

External gas socket	1,5 kg
---------------------	--------

Additional Dual AGM habitation battery, 12 V / 95 Ah	28 kg
--	-------

Additional power sockets (1 x 12 V / 2 x 230 V / 2 x dual USB-A/C)

Gas pressure regulator TRUMA DuoControl including automatic changeover, crash sensor, EisEx de-icing system and gas filter	2,4 kg
--	--------

Wireless alarm system with gas warning system for narcotic gases, propane and butane	1 kg
--	------

Smart Trailer System (vehicle levelling and fuel level indicator via E-Trailer app)	0,8 kg
---	--------

Remote display for gas pressure regulator TRUMA DuoControl	0,6 kg
--	--------

Lithium battery SUPER B Epsilon, 12 V / 150 Ah

External socket 12 V / 230 V, including satellite / TV connection	0,4 kg
---	--------

LED lighting

Ambient lighting, design dependent on model	0,3 kg
---	--------

Heating / air conditioning

Heating system TRUMA Combi 6 E, instead of Combi 6	1,1 kg
LCD control panel TRUMA Combi CP Plus	0,2 kg

Multimedia

CAMPERNET / TV combination consisting of LTE/WiFi router with dual SIM, high-performance multiband roof aerial for mobile streaming and WiFi near the vehicle, 22" Smart-TV TELECO including tuner / receiver and pull-out TV bracket

Satellite / TV combination consisting of TELECO satellite system, 22" Smart-TV TELECO including tuner / receiver and pull-out TV bracket

* Please note the following when consulting the technical details: The maximum technically permissible laden mass is the gross vehicle weight specified by the manufacturer, which must not be exceeded under any circumstances while driving the vehicle. In general, the "mass in running order" corresponds to the weight of the standard, empty vehicle in accordance with the manufacturer's specifications, and in the case of motorhomes and vans, includes the fuel tank filled to at least 90%, the mass of the driver (which is calculated at 75 kg), the fuel and liquids as well as the mass of the body, the cab, the trailer hitch (if fitted as standard) and the tyre repair set. For caravans, the mass in running order includes the mass of the vehicle equipped with standard equipment in accordance with the manufacturer's specifications, including fluids and the mass of the body, additional trailer hitches (if fitted as standard) and the tyre repair set. This is a calculated value, which is subject to legally permissible tolerances of up to $\pm 5\%$ (see note in brackets). Since the occurrence of legally permissible tolerances has a direct impact on the remaining loading capacity, these tolerances must be taken into account when configuring the vehicle. The maximum mass for optional extras is a value calculated for each layout that HOBBY uses to limit the available mass for optional extras that can be ordered and fitted at the factory. The aim of this value is to ensure that the legally prescribed minimum loading capacity is observed. If selecting optional extras increases the actual vehicle mass to such an extent that there is no longer sufficient available mass between the actual vehicle mass and the maximum technically permissible laden mass for the passengers (only with motorhomes and vans) and the minimum loading capacity, depending on the layout, you can choose to increase the load capacity of the vehicle (increase the maximum technically permissible laden mass) during the configuration. Alternatively, you can reduce the permitted number of people while driving (only for motorhomes and vans) and/or deselect optional extras. Otherwise, you will be unable to continue configuring the vehicle or proceed with the ordering process. For motorhomes and vans, the maximum number of permitted people while in transit specified in each case is dependent on the weight and axle load. It may be reduced when optional extras and accessories are installed, in which case individual seats must be removed to ensure the legally prescribed minimum loading capacity is observed. A weight of 75 kg is calculated for each person travelling, regardless of how much the passengers actually weigh. Since the driver is already included in the mass in running order, he/she is not included in the mass of the passengers. The capacity of the fresh water tank is reduced while taking into account the driving restriction (valve on the fresh water tank).



All information on variants, prices and weights can be found on our homepage.