

OPTIMA DE LUXE T70 GE

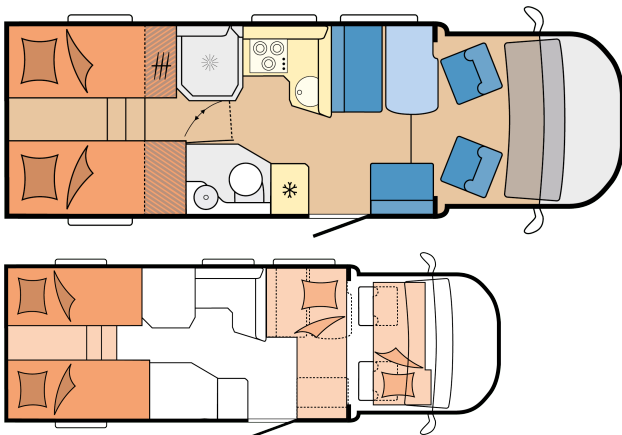

Overall length	7.473 mm
Total width	2.330 mm
Technically permissible gross weight	3.500 kg

TECHNICAL DATA

Model	T70 GE	Bed size, cab bed conversion (length x width)	1.600 x 740 mm
Number of axles	2	Fuel tank	75 l
Front wheel drive		AdBlue tank	19 l
Wheelbase	4.300 mm	Waste water tank	96 l
Tyre size	225 / 75 R 16 CP	Fresh water tank	10 / 100 l
Turning circle	15,30 m	Outside shower	Driver side
Overall length	7.473 mm	External socket	Passenger side
Overall width	2.330 mm	Roof-mounted air conditioning unit	Centre / rear
Overall height	2.872 mm	TV bracket	Entrance left
Interior headroom	2.054 mm	Fresh water tank	Bench seat / seatbelt anchor
Maximum technically permissible laden mass	3.500 kg	External gas socket	Passenger side
Unladen weight	3.013 kg	Additional power sockets, 2 x 12 V	
Mass in running order	3.049 kg	Additional power sockets, 2 x 230 V	
Payload	451 kg	Gas bottle locker	2 x 11 kg
Towing capacity, braked	2.000 kg	Number of power sockets (12 V / 230 V)	3 / 7
Body wall thickness (floor / roof / wall)	42 / 34 / 34 mm	Charger	25 A
Number of people when driving	4	Charge booster	25 A
Three-point seatbelts	4	Garage internal dimensions (length x width x height)	1.100 x 2.180 x 1.100 mm
Number of berths / optional berths	2 / 2	Garage door on passenger side (inner dimensions: width x height)	1.000 x 1.010 mm
Bed size, single beds (length x width)	2.030 x 800; 1.970 x 800 mm	Garage door on driver's side (inner dimensions: width x height)	1.000 x 1.010 mm
Bed size, seating area bed conversion (length x width)	2.120 x 1.000 / 680 mm		

HOBBYKOMPLETT

Engine: FIAT Ducato 2.2 l - 140 Multijet, Euro 6d-FINAL, 2.184 ccm, 103 kW / 140 hp, with start/stop technology and ECO pack | Chassis: FIAT Low-Frame Chassis Light, 3,500 kg | Wheel Rims: Alloy rims 16", original FIAT | Base vehicle: ABS anti-lock braking system, Wing mirrors, electrically adjustable and heated, Wing mirrors, extended, On-board computer, Diesel fuel tank, 75 litres, AdBlue tank, 19 litres, ESP including ASR, Hill Holder and intelligent traction control, Driver and passenger airbag, Electric windows, Air conditioning, manual with pollen filter in cab, Steering wheel and gearstick in leather finish, Radio antenna

Garages and lockers: Rear garage, insulated and heated, with robust floor covering, Garage door on passenger side with gas springs, Garage door on the driver's side with gas springs, Tie down rails and points in garage | Living area: Coat hooks in entrance area, Wall units with plenty of storage space, Wardrobe with interior light, Smooth transition from cab to habitation area | Furniture finish: Uni Black / Walnut | Upholstery combinations: Kos | Kitchen: Refrigerator (AES) DOMETIC, 133 litres, double-hinged, absorption technology, Designer 3-burner "Gas-on-Glass" hob with electric ignition, Stainless steel sink, Kitchen with generously-

integrated in roof area, Radio kit with loudspeakers, Tyre pressure monitoring system, Tyre repair set, Charge booster 25 A, Transmission, 6-speed manual, Mud flaps, front, Front bumper painted in body colour, Cruise control, Hazard triangle and first aid kit, Immobiliser, electronic, Central locking with remote control, FIAT "Safety" pack (includes emergency braking system, lane departure warning system, rain sensor, traffic sign recognition and auto-dimming headlights) | Design variants: Front end paint finish white, radiator grille and headlight mouldings black, decor black | Cab: Cup holder, Tablet holder and USB charging socket, Roof vent, can be opened, double-glazed and tinted, Driver and passenger seats with armrests "Captain's Chair", height-adjustable, Swivel driver and passenger seat, Driver and passenger seat covered in same upholstery as living area, Floor mat in the cab, All-round shelf, Blackout system REMIS for front and side cab windows | Windows: Framed windows, can be opened, double-glazed and tinted, Combi-cassettes with pleated blackout blind and insect screen, for all windows | Body: GRP floor with XPS heat insulation, GRP roof for optimal hail protection, Rooflight DOMETIC SEITZ, Midi-Heki 700 x 500 mm, with pleated blind and fly screen in living area, Rooflight DOMETIC SEITZ, Mini-Heki 400 x 400 mm, with pleated blind and fly screen in sleeping area, Rooflight DOMETIC SEITZ, Mini-Heki 400 x 400 mm, with pleated blind and fly screen in washroom, Rooflight DOMETIC SEITZ, Mini-Heki 400 x 400 mm, with pleated blind and fly screen in shower, Awning THULE OMNISTOR, width 400 cm, pull-out depth 250 cm, Entrance door, extra wide with double lock, window, waste bin and compartments, inner dimensions: 605 x 1,740 mm, Fly screen for habitation entrance door, Grab handle, Double entry step, electrically operated, LED entry light, Rear lights with dynamic indicator, Gas bottle pull-out shelf, accommodates 2 x 11 kg bottles, Apron rails made of aluminium, Winter vents for seating area, lockers and beds | Garages and lockers: Lowered rear with XPS heat insulation |

sized, fully-extendable drawers with soft-close mechanism, Kitchen counter, Spice racks, Cutlery insert, Kitchen power socket | Sleeping area: Single beds, Slatted frame system GOODSIDE®, Bed head panel and shelving, All-round wall units above bed, Under-bed linen compartment, Light switch in sleeping area | Washroom: Open-plan washroom design with separate shower cubicle, design dependent on model, Shower screen, Shower column with shower fitting and compartments, Swivel toilet THETFORD, Washing line, extendable, Mirror cabinet | Water / gas / electricity: Waste water tank, 96 litres, insulated and heated, Fresh water tank, 10 / 100 litres, frost-protected, AGM habitation battery, 12 V / 95 Ah, Frost-protected installation in the floor pedestal, Gas regulator with over-pressure protection (DIN EN 12 864) and hose line, Gas control taps in kitchen unit, Power supply, 12 V / 230 V, Power sockets in garage, 12 V / 230 V, Twin submersible pump, Smoke alarm, Pre wired for reversing camera, Pre wiring for solar power system, Additional power sockets, 2 x 12 V / 2 x 230 V | LED lighting: Reading lights in sleeping area, Reading lights in seating area, Ambient lighting, design dependent on model, Ceiling light in living and sleeping area, Work surface lighting in the kitchen, Garage lighting | Smart Home: HOBBY CONNECT, controls for on-board technology via Hobby control panel and Bluetooth using app | Heating / air conditioning: Heating system TRUMA Combi 6 including 10-litre hot water supply system and frost monitor valve, LCD control panel TRUMA Combi CP Plus, Hot water supply in kitchen and washroom | Multimedia: Loudspeaker for seating area, x 2, Navigation system and Wi-Fi media centre PIONEER with touchscreen, reversing camera, pitch database, Apple CarPlay and Android Auto, Pre wired for satellite system, TV connection, including 12 V / 230 V and antenna socket |

Engine

FIAT Ducato 2.2 I – 160 Multijet Power, Euro 6d-FINAL, 2.184 ccm, 118 kW / 160 hp, with start / stop technology and ECO pack

Chassis

FIAT Low-Frame Chassis Maxi, 4,250 kg (only in conjunction with 140 hp engine)	40 kg
FIAT Low-Frame Chassis Maxi, 4,400 kg (only in conjunction with 160 hp engine)	40 kg

Increase / decrease in load capacity

Increase in load capacity to 3,650 kg, without any technical modifications

Base vehicle

Diesel fuel tank, 90 litres	13 kg
LED daytime running light	0,2 kg
Automatic transmission, 9-speed	18 kg
Air conditioning, automatic	
Fog lights	2 kg
Trailer hitch SAWIKO, detachable	29 kg
Trailer hitch SAWIKO, fixed	29 kg
Heated windscreen	2 kg
HOBBY "Plus" pack (includes electric parking brake, keyless entry & go, inductive mobile phone charger, Techno Trim dashboard design and fully digital dashboard)	2 kg
FIAT "Easy Driving" pack (includes adaptive cruise control, intelligent speed assistant and driver drowsiness detection)	0,5 kg
FIAT "Antifogging Plus" pack (includes heated windscreen and Webasto parking heater)	4,6 kg

Design variants

Front end paint finish black, radiator grille and headlight mouldings silver, decor black

Front end paint finish black, black design pack

Cab

Thermal curtains including footwell insulation	4,5 kg
--	--------

Body

Rooflight DOMETIC SEITZ, Midi-Heki 700 x 500 mm, with pleated blind and fly screen in sleeping area	4,5 kg
Bicycle rack THULE for 2 bicycles, loading capacity 60 kg	8 kg
Bicycle rack THULE for 3 bicycles, loading capacity 60 kg	11 kg
Bicycle rack THULE for 4 bicycles, loading capacity 60 kg	14 kg
Rear corner steadies	6 kg

Living area

L-shaped seating area with single-post lift table, can be rotated through 360°, design dependent on model	15 kg
Carpet in the living area, removable	10 kg

Kitchen

Oven with electric ignition and light	16 kg
Extractor hood DOMETIC	3 kg

Sleeping area

Bed extension including cold foam mattress and ladder	4,8 kg
Bed conversion for seating group incl. cushion	2 kg
Bed conversion for cab including cushion	10 kg

Water / gas / electricity

Outside shower, cold water	0,5 kg
External socket 12 V / 230 V, including satellite / TV connection	0,4 kg
External gas socket	1,5 kg
Smart Trailer System (vehicle levelling and fuel level indicator via E-Trailer app)	0,8 kg
Gas pressure regulator TRUMA DuoControl including automatic changeover, crash sensor, EisEx de-icing system and gas filter	2,4 kg
Remote display for gas pressure regulator TRUMA DuoControl	0,6 kg
Wireless alarm system with gas warning system for narcotic gases, propane and butane	1 kg
Dual USB charging socket, 1 per living and sleeping area	0,1 kg
Additional AGM habitation battery, 12 V / 95 Ah	28 kg

Smart Home

HOBBY-CONNECT+, remote control for on-board technology via mobile communications using app	0,6 kg
--	--------

Heating / air conditioning

Roof-mounted air conditioning unit DOMETIC FreshJet including CI-BUS, with heating function, without lighting, 2.2 KW	32 kg
Pre wiring for roof-mounted air conditioning unit	1,5 kg
Heating system TRUMA Combi 6 E, instead of Combi 6	1,1 kg

Multimedia

Satellite/TV combination consisting of TELECO satellite system, 22" LED flat screen TV including tuner/receiver and DVD player, pull-out TV bracket	15,4 kg
---	---------